

Z 31

1092

FACIT PE 1500

TAPE PUNCH

SPARE PARTS



FACIT AB · SOLNA · SWEDEN

Table of contents

1 GENERAL

2 MECHANICAL UNIT PE 1501, 1502, 1503, 1504 AND 1505

2.1 CASE AND COVER

2.2 BASE WITH ELECTRICAL DETAILS AND LUBRICATION SYSTEMS

2.3 TAPE SUPPLY REEL

2.4 TAPE GUIDE PLATES

2.5 TAPE FEED MECHANISM

2.6 MAIN SHAFT AND TAPE FEED ARM

2.7 PUNCH MECHANISM

3 ELECTRONIC UNIT PE 1507 AND 1508

3.1 CHASSIS AND COVER

3.2 CABLE CONNECTORS

3.3 CONTROLS

3.4 POWER UNIT

3.5 ETCHED CIRCUIT BOARDS

4 ACCESSORIES

1 GENERAL

This parts list designates parts for the following models of the high speed punch FACIT PE 1500.

Mechanical units: PE 1501, 1502, 1503, 1504 and 1505.

Electronic units: PE 1507 and 1508.

The disassembly, assembly and change of most mechanical parts should only be undertaken according to special instructions. These will be available when contacting our service department. We recommend our customers to send the mechanical unit to our service department for overhaul after about every 1500th roll (or about 180 million punched characters).

Screws, washers and nuts which are not of special design are designated according to Swedish SIS standards. They are bound to their corresponding details by brackets in this parts list.

All semi-conductors in the electronic units should be submitted to our test instructions.

1 GENERAL

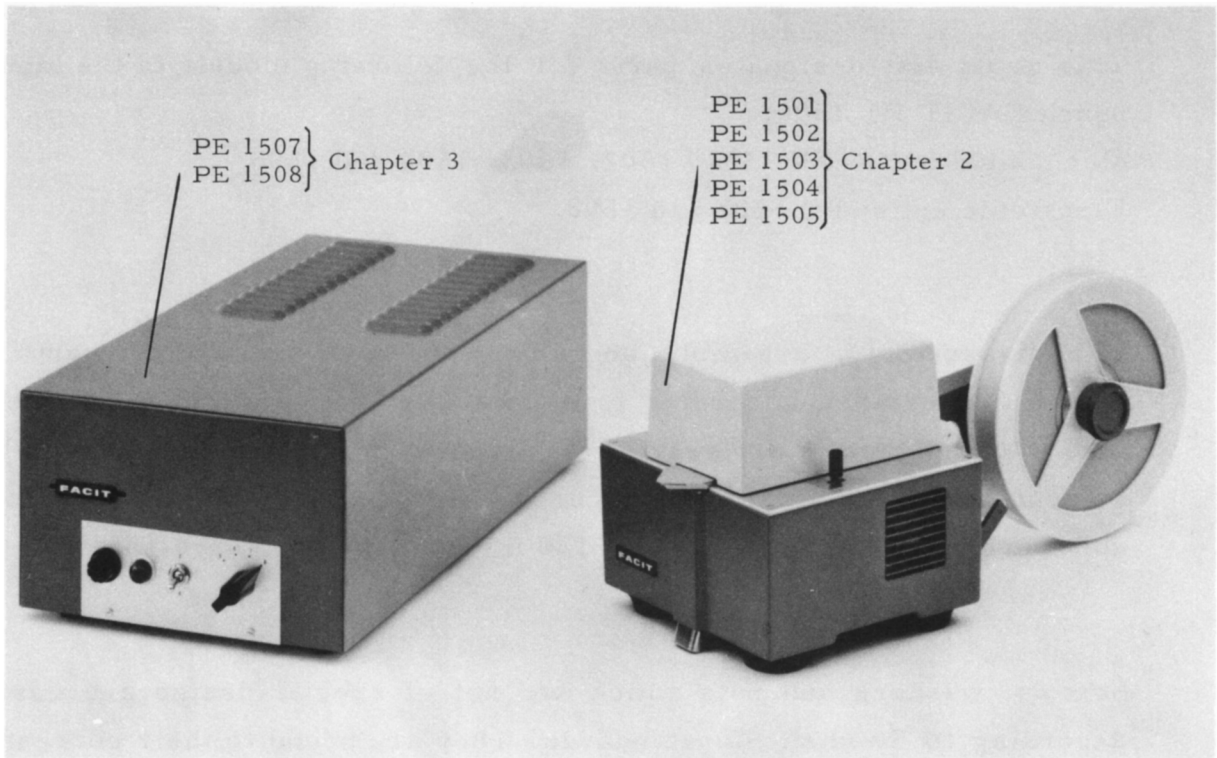

<u>Designation</u>	<u>Description</u>	<u>Note</u>
PE 1501	Mechanical unit 5-8 channels 220V 50 cycles	Special applications
PE 1502	Mechanical unit 5-8 channels 220V 60 cycles	
PE 1503	Mechanical unit 5-8 channels 115V 50 cycles	
PE 1504	Mechanical unit 5-8 channels 115V 60 cycles	
PE 1505	Mechanical unit 5 channels 220V 50 cycles	
PE 1507	Electronic unit 5-8 channels 220V 50-60 cycles	
PE 1508	Electronic unit 5-8 channels 115V 50-60 cycles	

2 MECHANICAL UNIT PE 1501, 1502, 1503, 1504 AND 1505

- 2.1 CASE AND COVER
- 2.2 BASE WITH ELECTRICAL DETAILS AND LUBRICATION SYSTEMS
- 2.3 TAPE SUPPLY REEL
- 2.4 TAPE GUIDE PLATES
- 2.5 TAPE FEED MECHANISM
- 2.6 MAIN SHAFT AND TAPE FEED ARM
- 2.7 PUNCH MECHANISM

2 MECHANICAL UNIT PE 1501, 1502, 1503, 1504 AND 1505

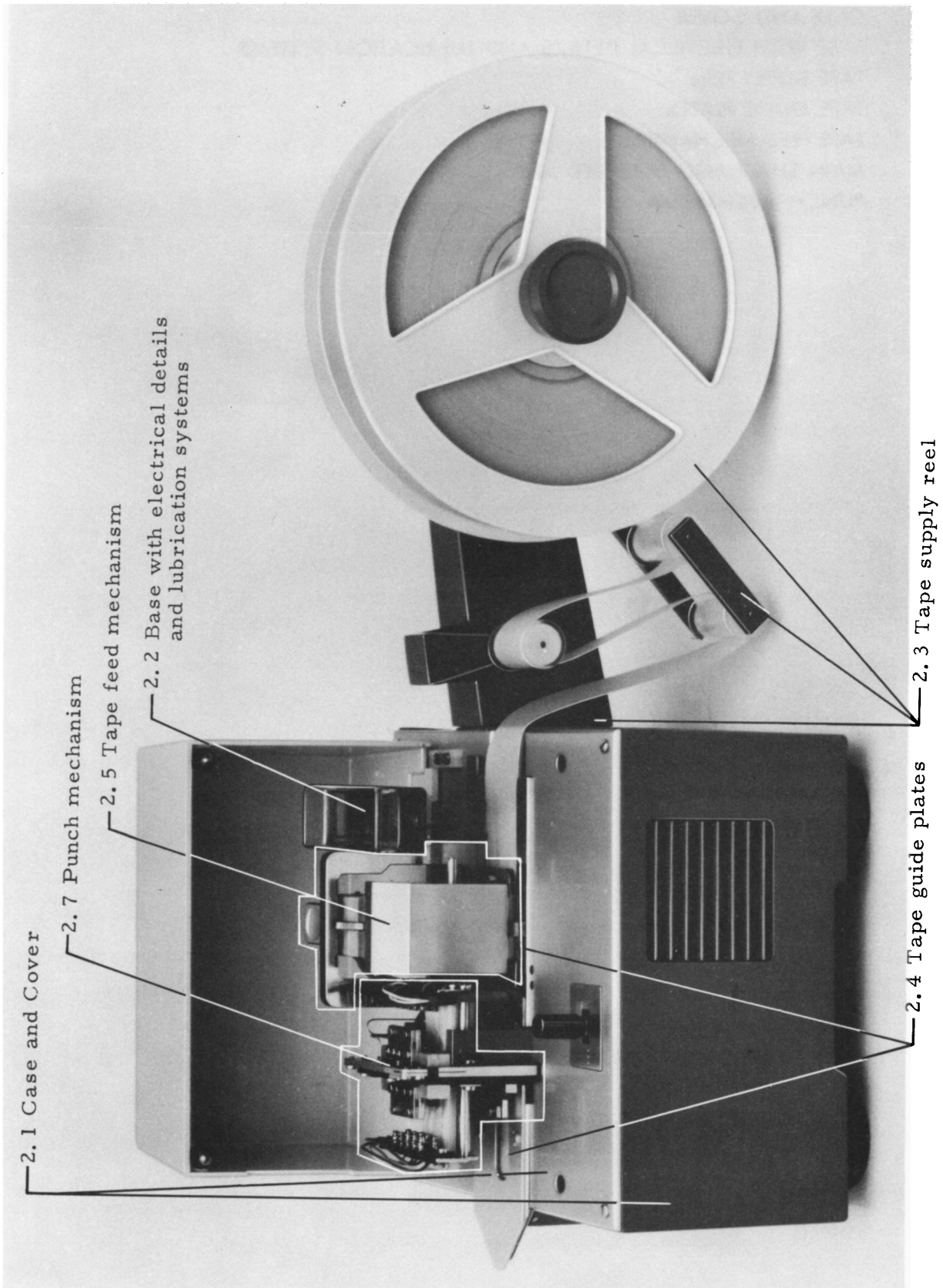

2.1 CASE AND COVER

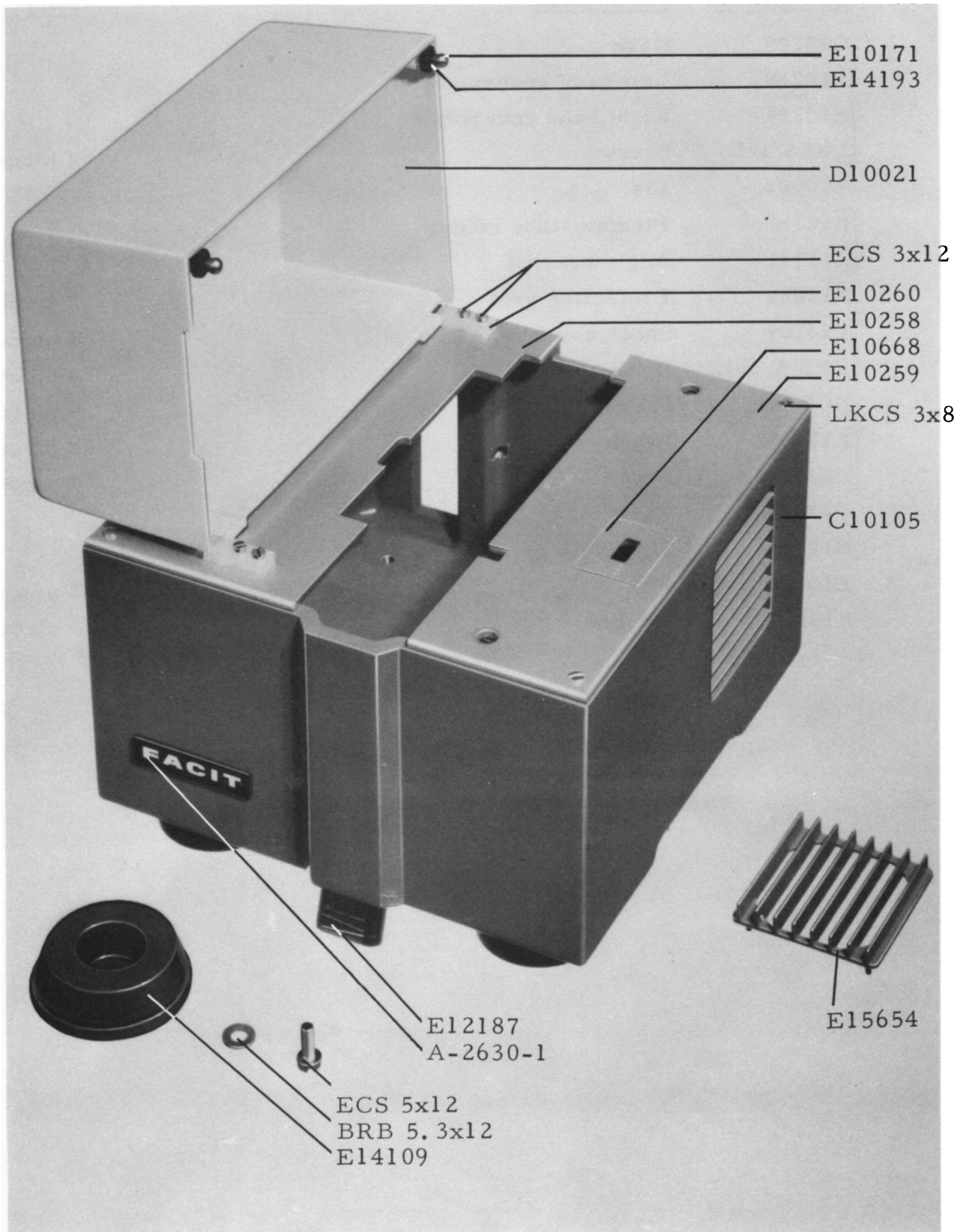

2.1 CASE AND COVER

<u>Designation</u>	<u>Description</u>	<u>Note</u>
C10105	Case	
E10258	Left hand coverplate	
E10259	Right hand coverplate	
LKCS 3x8	Screw	4 pieces
D10021	Lid	
E12187	Flexible-tube holder	
E15731	Angle bracket	
E15654	Protective grid	2 pieces
E14109	Shock absorber	4 pieces
BRB 5.3x12	Washer	4 pieces
ECS 5x12	Screw	4 pieces
E10260	Hinge	2 pieces
ECS 3x12	Screw	4 pieces
A-2630-1	Facit Sign	
E10668	Sign plate	
E10171	Pin	2 pieces
E14193	Washer	2 pieces

2.2 BASE WITH ELECTRICAL DETAILS AND LUBRICATION SYSTEMS

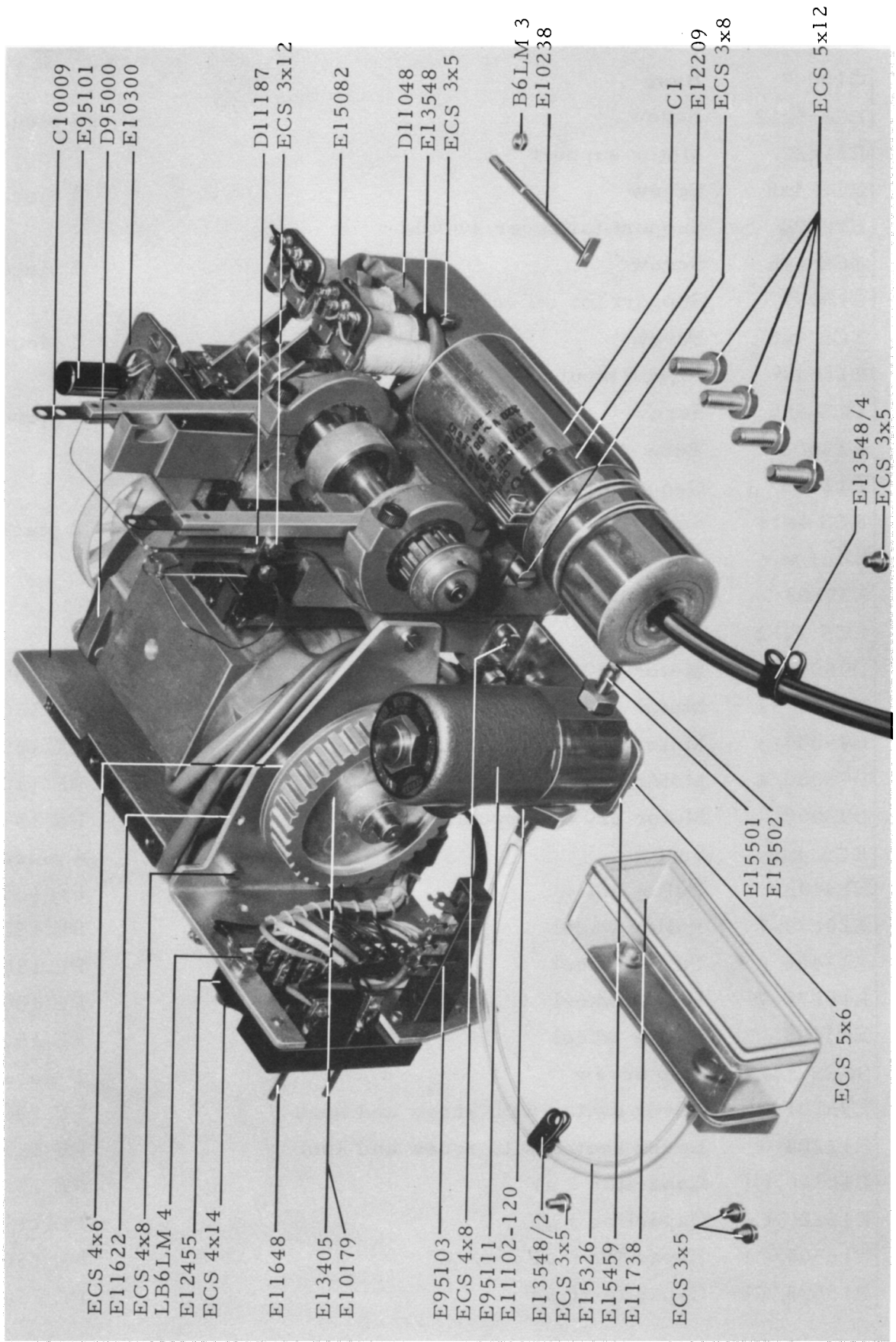

2.2 BASE WITH ELECTRICAL DETAILS AND LUBRICATION SYSTEMS

<u>Designation</u>	<u>Description</u>	<u>Note</u>
C10009	Base	
ECS 5x12	Screw	4 pieces
E11622	Motor support	
ECS 4x8	Screw	3 pieces
E10300	Support for lever switch	
ECS 4x6	Screw	2 pieces
E15459	Support for oil valve	
ECS 4x8	Screw	2 pieces
E11648	Power input assembly	
ECS 4x8	Screw	2 pieces
E15502	Tube	
E12455	Connector, Tuchel L2070	
ECS 4x14	Screw	2 pieces
LB6LM 4	Nut	
E95103	Soldering lug support, Philips 88033	
ECS 3x12	Screw	
D95000	Motor 220V 50 cycles	PE 1501
D95000/2	Motor 220 V 60 cycles	PE 1502
D95000/3	Motor 115V 50 cycles	PE 1503
D95000/4	Motor 115V 60 cycles	PE 1504
D95000	Motor 220V 50 cycles	PE 1505
ECS 4x6	Screw	4 pieces
E13405	Pulley wheel	PE 1501
E10179-7	Pulley wheel	PE 1502
E13405	Pulley wheel	PE 1503
E10179-7	Pulley wheel	PE 1504
E13405	Pulley wheel	PE 1505
SKSS 3x4	Stop screw	2 pieces
E95101	Lever switch with screw and knob	PE 1501-1504
E12208/7	Lever switch with screw and knob	PE 1505
C10340/C1	Capacitor 3 μ F	PE 1501
E15220/C1	Capacitor 3 μ F	PE 1502
E15504/C1	Capacitor 6 μ F	PE 1503
E15505/C1	Capacitor 6 μ F	PE 1504

<u>Designation</u>	<u>Description</u>	<u>Note</u>
E12209	Capacitor support with screw and nut	
ECS 3x8	Screw	
E11738	Oil container	
ECS 3x5	Screw	2 pieces
E15326	Tub	
E13548/2	Cable clamp	2 pieces
ECS 3x5	Screw	2 pieces
D11187	Oil tubes with support	
ECS 3x10	Screw	2 pieces
E95111	Oil valve 220V 50 cycles	PE 1501
E95111	Oil valve 220V 50 cycles	PE 1502
E95111/2	Oil valve 115V 50 cycles	PE 1503
E95111/2	Oil valve 115V 50 cycles	PE 1504
E95111	Oil valve 220V 50 cycles	PE 1505
ECS 5x6	Screw	2 pieces
E15082	Pulse transmitter	3 pieces
E10238	Core	6 pieces
B6LM 3	Nut	6 pieces
D11048	Cable	PE 1501 -1504
D10133	Cable	PE 1505
E13548	Cable clamp	
ECS 3x5	Screw	7 pieces
E15501	Nipple	
E14193/2	Washer	
E11102-120	Nipple	
E95117	Washer	
E13548/4	Cable clamp	
ECS 3x5	Screw	

2.3 TAPE SUPPLY REEL

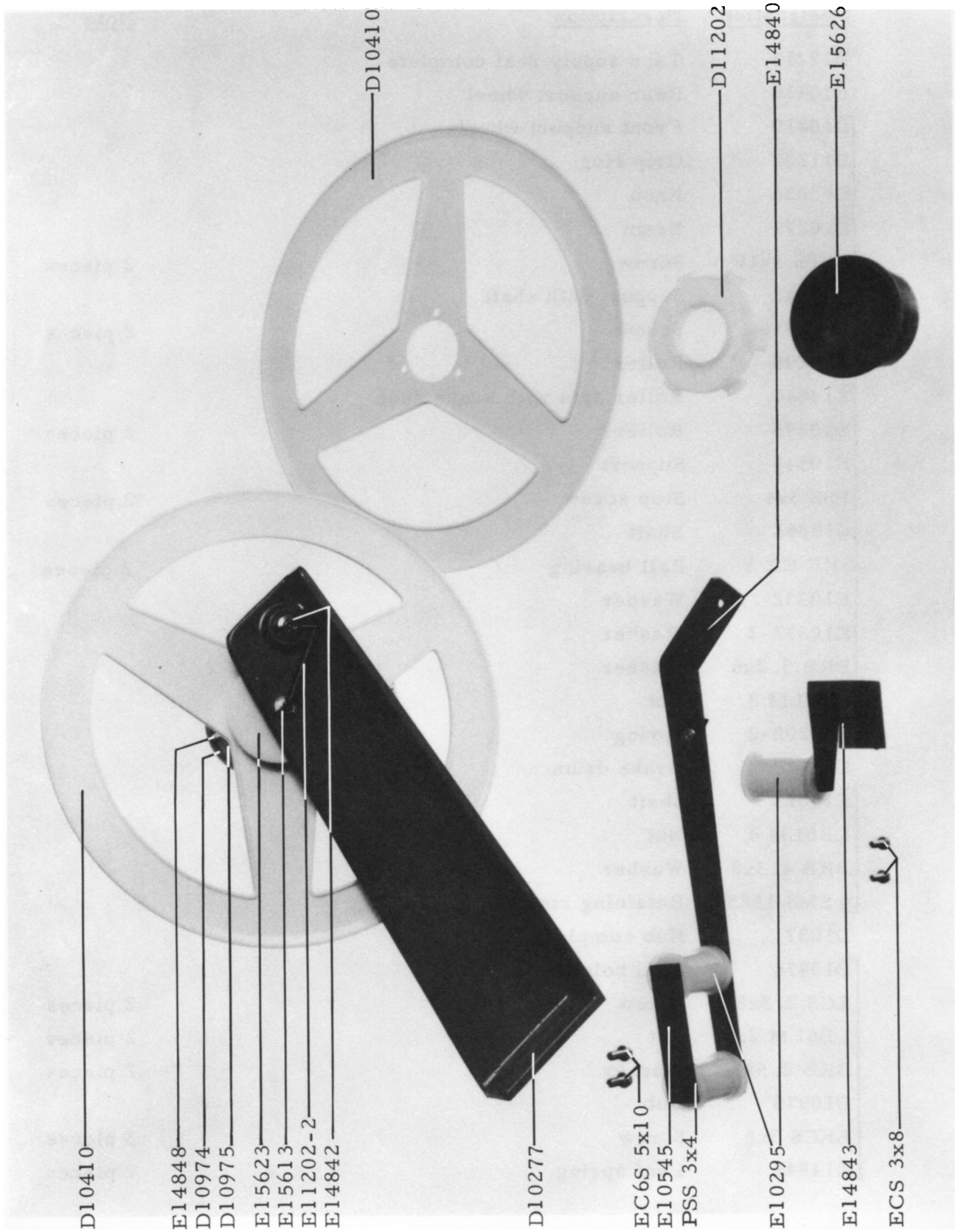

2.3 TAPE SUPPLY REEL

<u>Designation</u>	<u>Description</u>	<u>Note</u>
E12213	Tape supply reel complete	
D10410	Rear support wheel	
D10410	Front support wheel	
D11202	Grip ring	
E15626	Knob	
D10277	Beam	
EC6S 5x10	Screw	2 pieces
E14843	Support with shaft	
ECS 3x8	Screw	2 pieces
E10295	Roller	
E14840	Roller arm with brake shoe	
E10295	Roller	2 pieces
E10545	Support	
PSS 3x4	Stop screw	2 pieces
E14842	Shaft	
SKF EL 3	Ball bearing	2 pieces
E10332	Washer	
E10332-2	Washer	
BRB 3. 2x6	Washer	
LB6LM 3	Nut	
E11202-2	Spring	
E15623	Brake drum	
E15613	Shaft	
LB6LM 4	Nut	
BRB 4. 3x8	Washer	
4 SMS 1583	Retaining ring	
D10371	Hub complete	
D10974	<i>Real holder</i>	
ECS 2. 3x5	Screw	2 pieces
LB6LM 2. 3	Nut	2 pieces
BRB 2. 5x5	Washer	2 pieces
D10975	Hub	
LKCS 3x6	Screw	3 pieces
E14848	Leaf spring	2 pieces

2.4 TAPE GUIDE PLATES

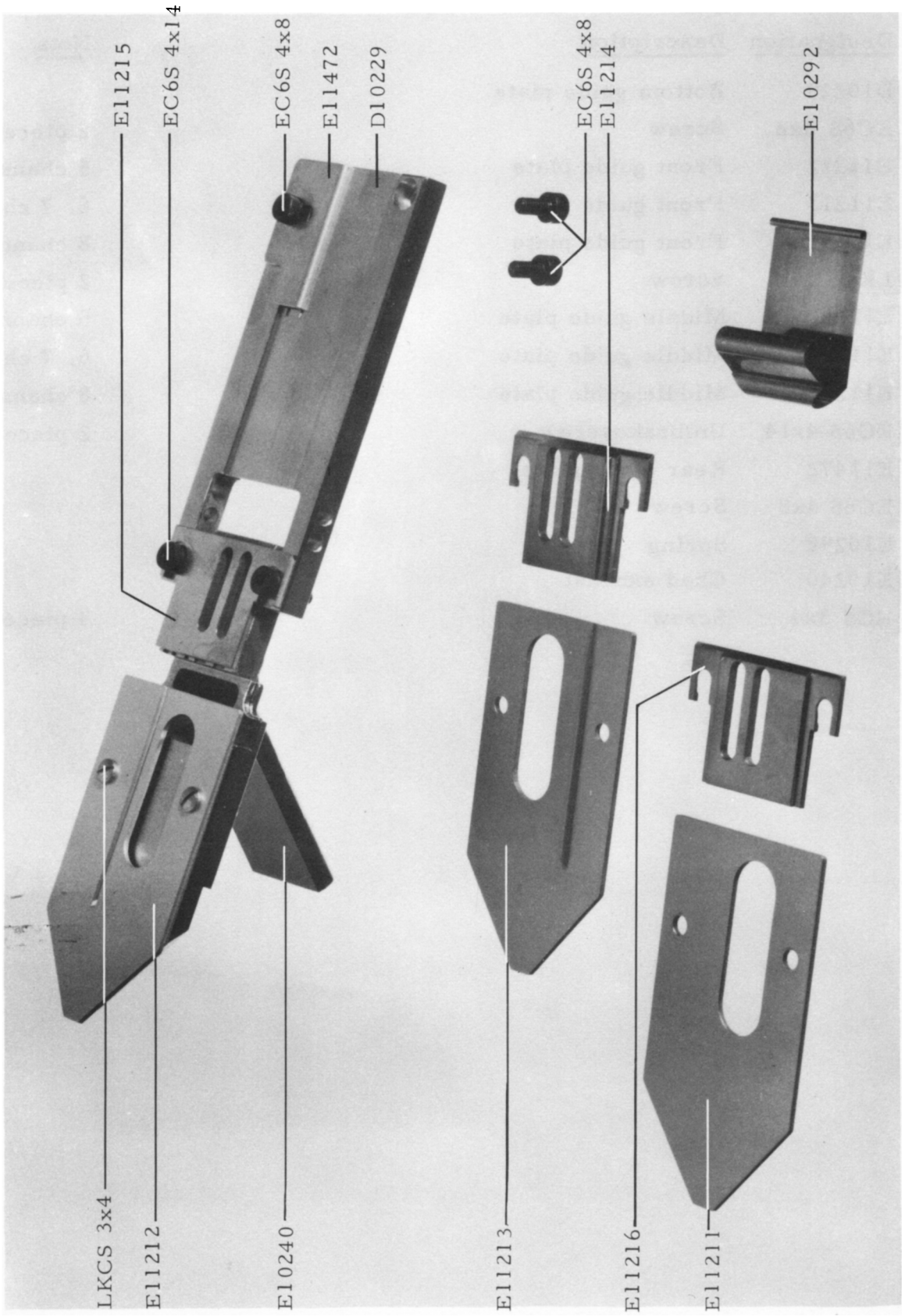

2.4 TAPE GUIDE PLATES

<u>Designation</u>	<u>Description</u>	<u>Note</u>
D10229	Bottom guide plate	
EC6S 4x8	Screw	2 pieces
E11212	Front guide plate	5 channel
E11213	Front guide plate	6, 7 channel
E11211	Front guide plate	8 channel
LKCS 3x4	Screw	2 pieces
E11215	Middle guide plate	5 channel
E11214	Middle guide plate	6, 7 channel
E11216	Middle guide plate	8 channel
EC6S 4x14	Umbrakoscrew	2 pieces
E11472	Rear guide plate	
EC6S 4x8	Screw	
E10292	Spring	
E10240	Chad exhaust	
ECS 3x4	Screw	4 pieces

2.5 TAPE FEED MECHANISM

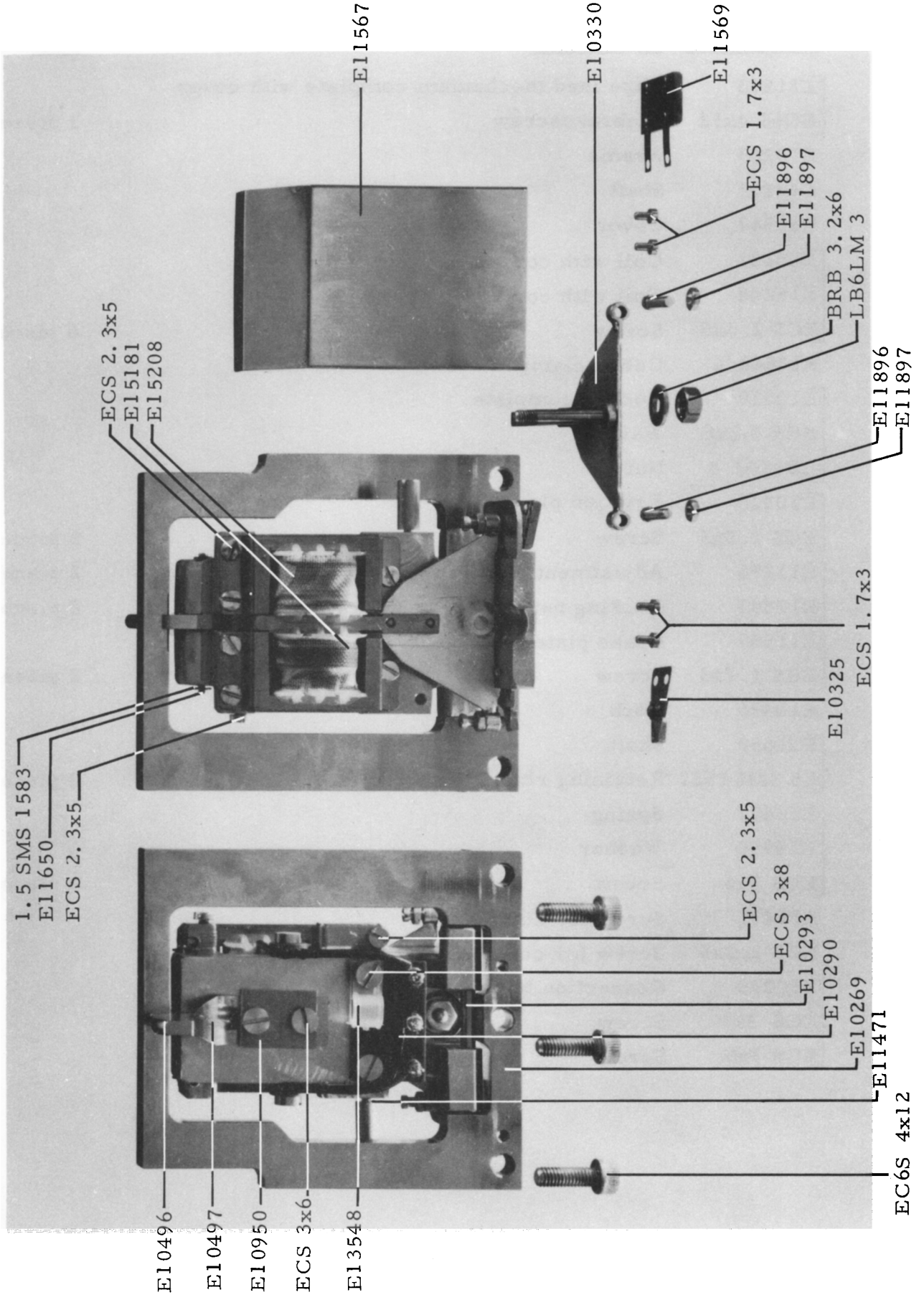

2.5 TAPE FEED MECHANISM

<u>Designation</u>	<u>Description</u>	<u>Note</u>
E11573	Tape feed mechanism complete with cover	
EC6S 4x12	Umbrakoscrew	3 pieces
E10269	Frame	
E10293	Shaft	
E11567	Cover	
E15181	Coil with core	
E15208	Coil with core	
ECS 2.3x5	Screw	6 pieces
E13548/4	Cable clamp	
E10330	Rocker complete	
BRB 3.2x6	Washer	
LB6LM 3	Nut	
E10325	Friction plate	
ECS 1.7x3	Screw	2 pieces
E11896	Adjustment screw	2 pieces
E11897	Locking nut	2 pieces
E11569	Brake plate	
ECS 1.7x3	Screw	2 pieces
E10496	Lock	
E11650	Shaft	
1.5 SMS 1583	Retaining ring	2 pieces
E10497	Spring	
E10950	Washer	
ECS 3x6	Screw	2 pieces
E11471	Screw for cover	
ECS 2.3x5	Screw for cover and oil tube	
E10290	Connection terminal board	
ECS 3x8	Screw	
ECS 3x6	Screw	

2.6 MAIN SHAFT AND TAPE FEED ARM

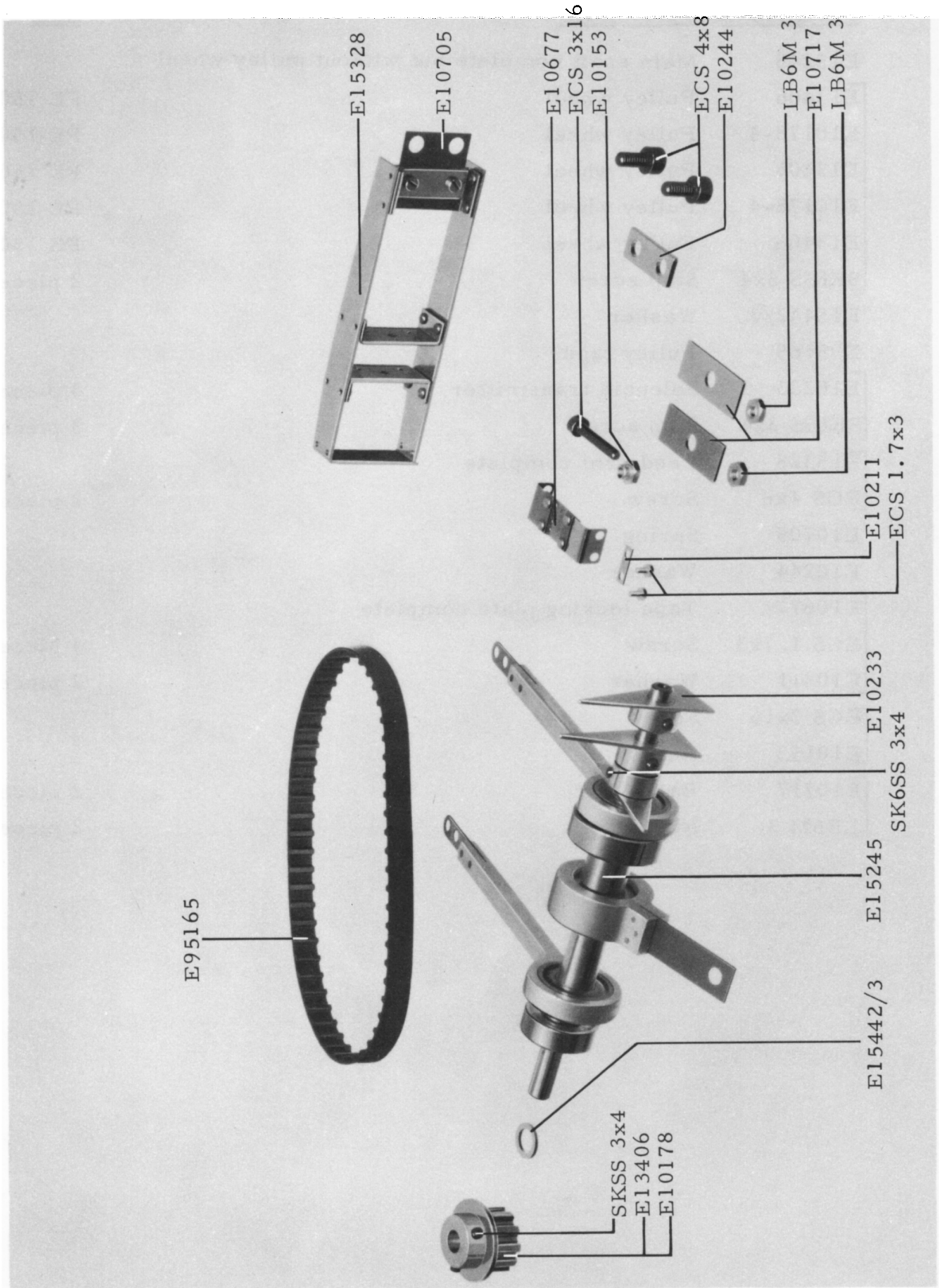

2.6 MAIN SHAFT AND TAPE FEED ARM

<u>Designation</u>	<u>Description</u>	<u>Note</u>
E15245	Main shaft complete but without pulley wheel	
E13406	Pulley wheel	PE 1501
E10178-4	Pulley wheel	PE 1502
E13406	Pulley wheel	PE 1503
E10178-4	Pulley wheel	PE 1504
E13406	Pulley wheel	PE 1505
SK6SS 3x4	Stop screw	2 pieces
E15442/3	Washer	
E95165	Pulley tape	
E10233	Solenoid transmitter	3 pieces
SK6SS 3x4	Stop screw	3 pieces
E15328	Feed arm complete	
ECS 4x8	Screw	2 pieces
E10705	Spring	
E10244	Washer	
E10677	Tape locking plate complete	
ECS 1.7x3	Screw	4 pieces
E10211	Washer	2 pieces
ECS 3x16	Screw	
E10153	Nut	
E10717	Bar	2 pieces
LB6M 3	Nut	2 pieces

2.7 PUNCH MECHANISM

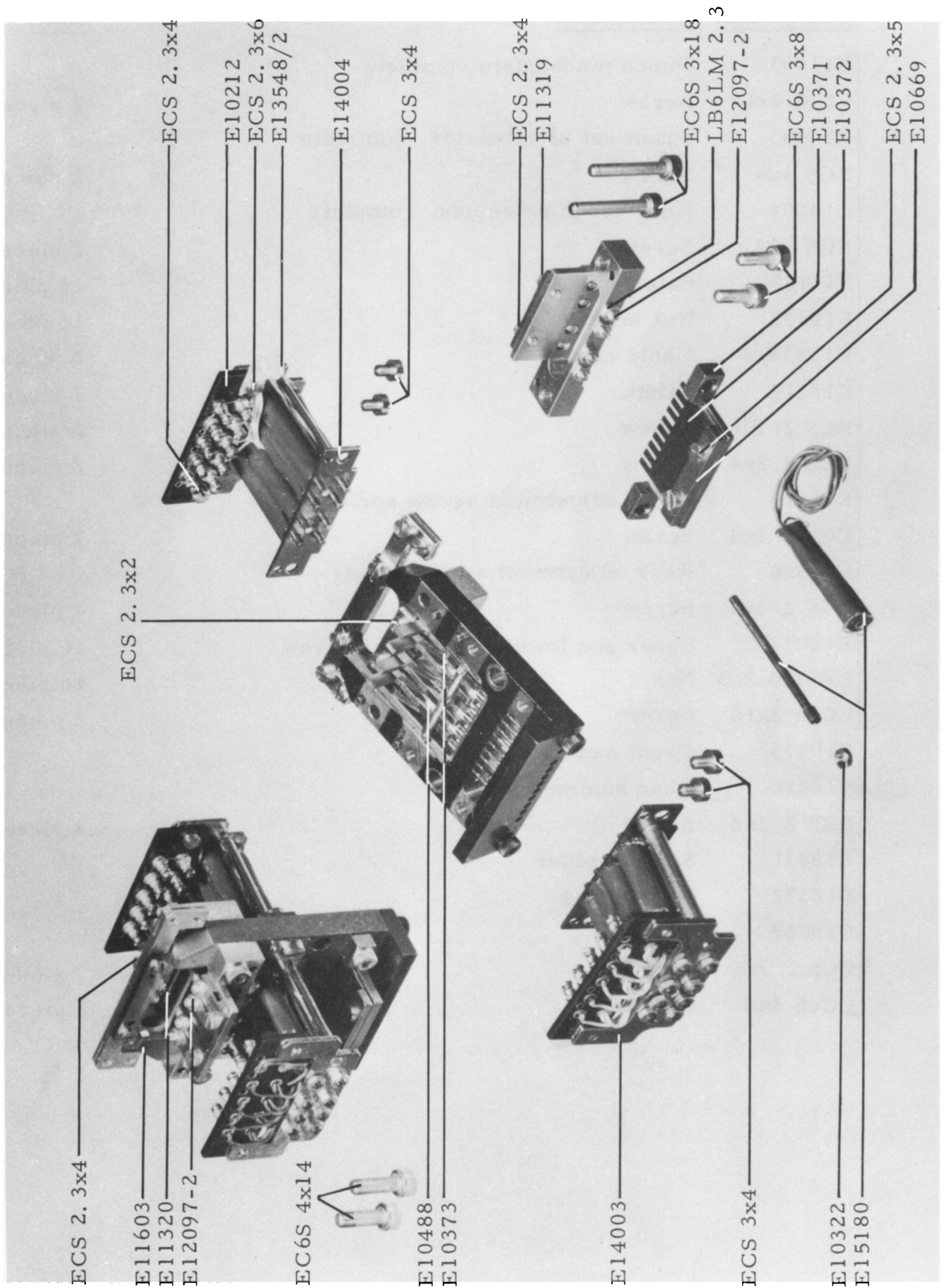

2.7 PUNCH MECHANISM

<u>Designation</u>	<u>Description</u>	<u>Note</u>
E11603	Punch mechanism complete	
EC6S 4x14	Screw	2 pieces
E14003	Front set of solenoids, complete	
ECS 3x4	Screw	2 pieces
E14004	Rear set of solenoids, complete	
ECS 3x4	Screw	2 pieces
E15180	Solenoid	16 pieces
E10322	Nut for core	16 pieces
E13548/2	Cable clamp	2 pieces
E10212	Plinth	2 pieces
ECS 2.3x6	Screw	2 pieces
ECS 2.3x4	Screw	2 pieces
E11319	Front adjustment screw spring	
ECS 2.3x4	Screw	2 pieces
E11320	Rear adjustment screw spring	
ECS 2.3x4	Screw	2 pieces
E12097-2	Upper and lower adjustment screw	16 pieces
LB6LM 2.3	Nut	16 pieces
EC6S 3x18	Screw	2 pieces
E10373	Front hammer spring	
E10488	Rear hammer spring	
ECS 2.3x2	Screw	4 pieces
E10371	Spring holder	
E10372	Stop spring	
E10669	Washer	
ECS 2.3x5	Screw	2 pieces
EC6S 3x8	Screw	2 pieces

- 3 ELECTRONIC UNIT PE 1507 AND 1508
 - 3.1 CHASSIS AND COVER
 - 3.2 CABLE CONNECTORS
 - 3.3 CONTROLS
 - 3.4 POWER UNIT
 - 3.5 ETCHED CIRCUIT BOARDS

3 ELECTRONIC UNIT PE 1507 AND 1508

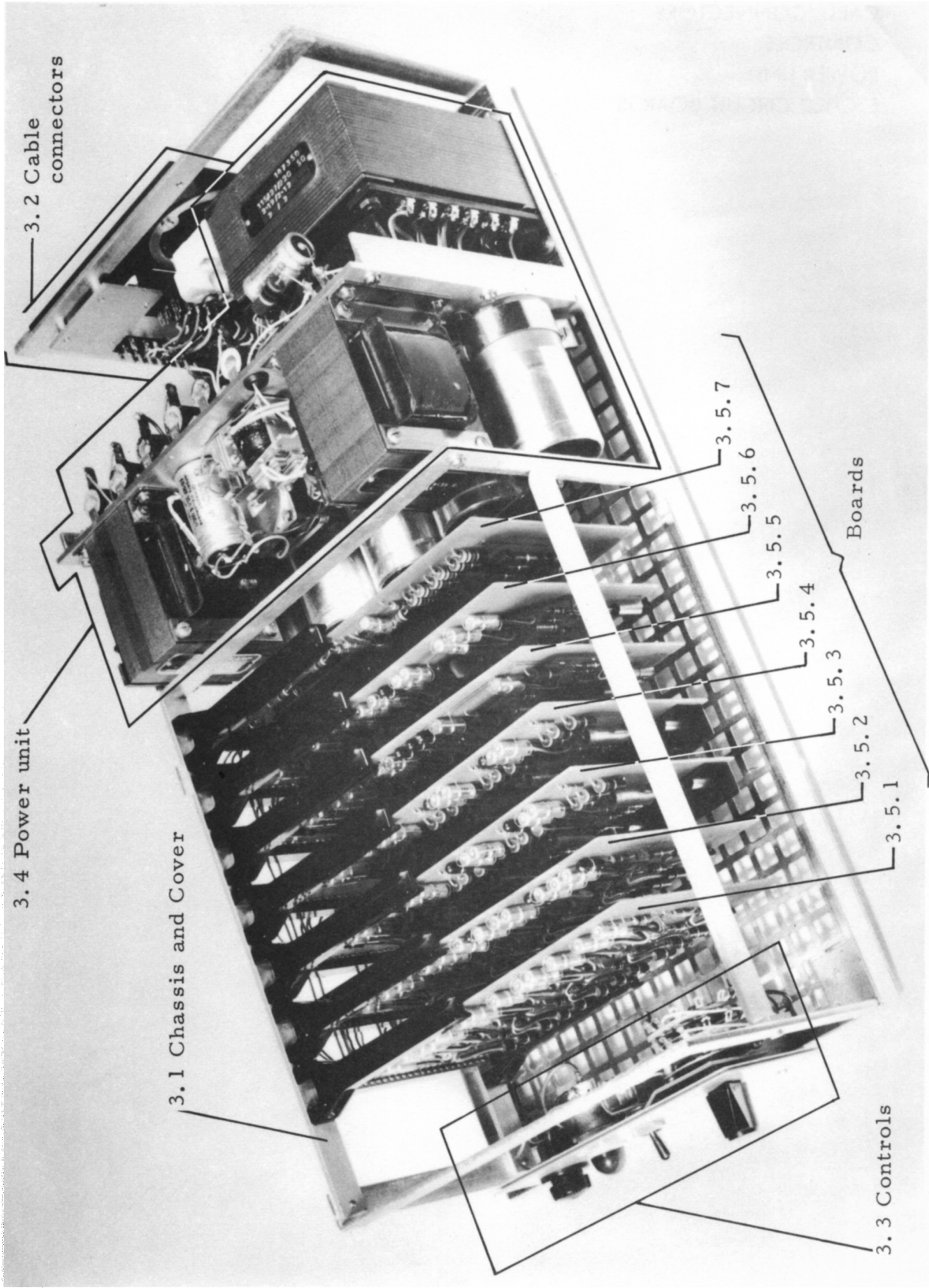

3.1 CHASSIS AND COVER

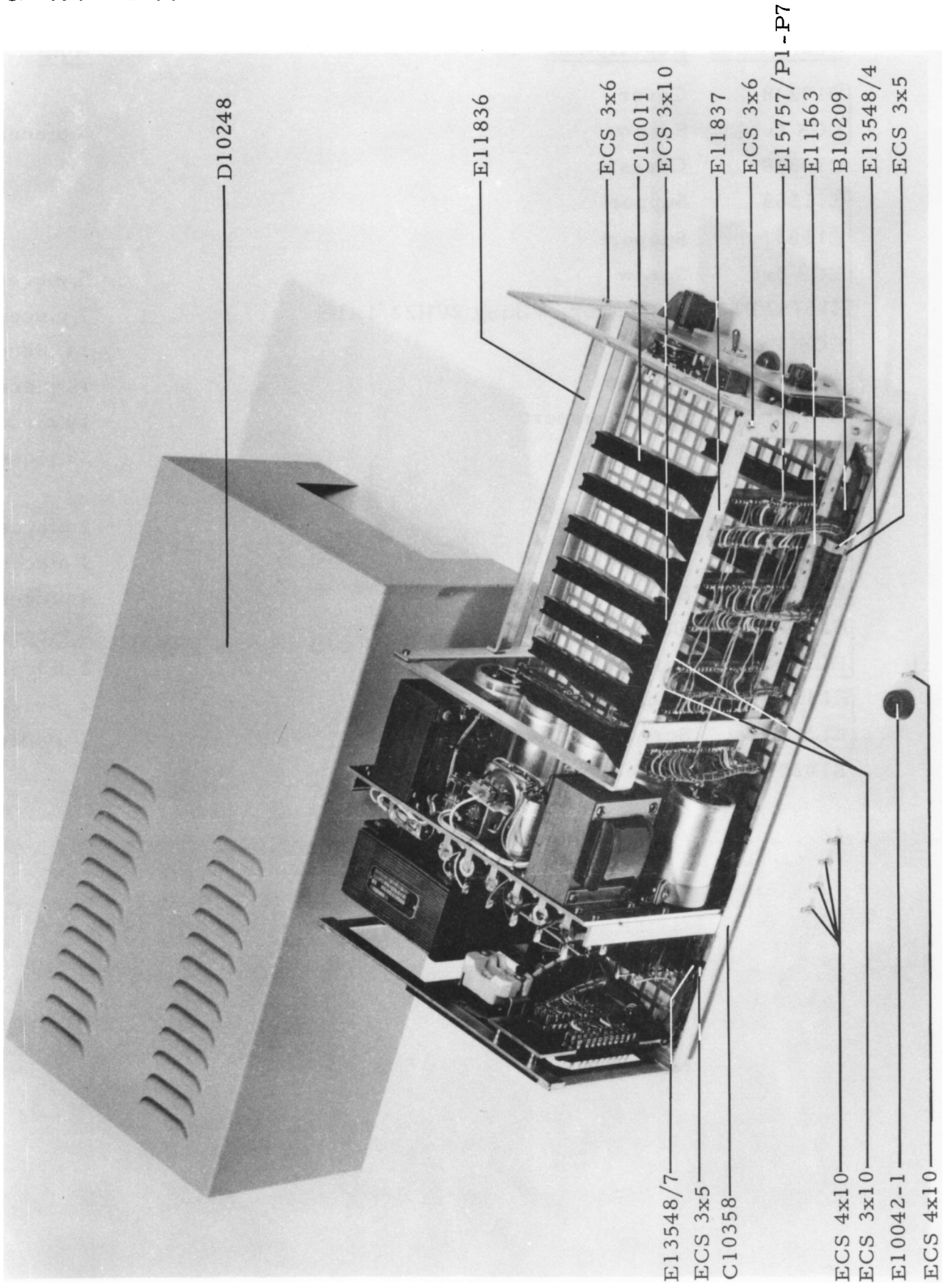

3.1 CHASSIS AND COVER

<u>Designation</u>	<u>Description</u>	<u>Note</u>
D10248	Cover	
ECS 4x10	Screw	4 pieces
C10358	Chassis	
E11563	Support	
E11837	Support	
ECS 3x6	Screw	5 pieces
E15757/P1-P7	Connector, Viking 2VH22/1AB5	7 pieces
ECS 3x10	Screw	14 pieces
FDB 3.1	Washer	14 pieces
C10011	Board support	14 pieces
ECS 3x10	Screw	28 pieces
E11836	Mounting	
ECS 3x6	Screw	2 pieces
E10042-1	Rubber	4 pieces
ECS 4x10	Screw	4 pieces
E13548/7	Cable clamp	2 pieces
ECS 3x5	Screw	2 pieces
E13548/4	Cable clamp	2 pieces
ECS 3x5	Screw	2 pieces
B10209	Cable harness	

3.2 CABLE CONNECTORS

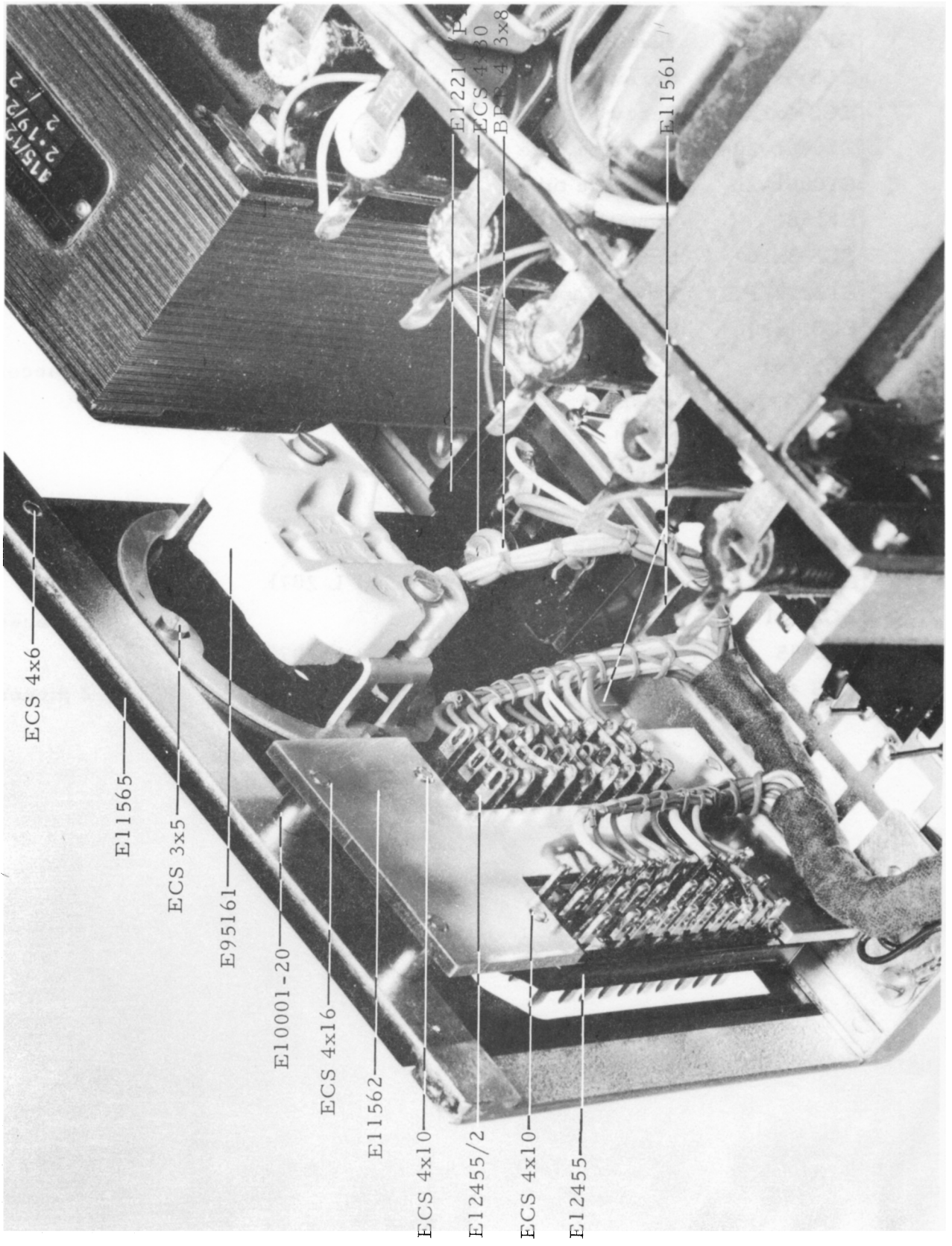

3.2 CABLE CONNECTORS

<u>Designation</u>	<u>Description</u>	<u>Note</u>
E11565	Panel	
ECS 4x6	Screw	
ECS 4x16	Screw	4 pieces
E10001-20	Distance tube	2 pieces
E10001-21	Distance tube	2 pieces
E11561	Mounting	
ECS 3x10	Screw	2 pieces
E12210/P1	Power input assembly Ätv. Facit B-2150-5	
ECS 4x30	Screw	
ECS 3x4	Screw	2 pieces
BRB 4. 3x8	Washer	
LB6M 4	Nut	
E95161	Power connector	
ECS 3x6	Screw	4 pieces
E11562	Mounting	
E12455/2	Terminal connector Tuchel L 2071	
ECS 4x10	Screw	2 pieces
E12455	Terminal connector Tuchel L 2070	
ECS 4x10	Screw	2 pieces

3.3 CONTROLS

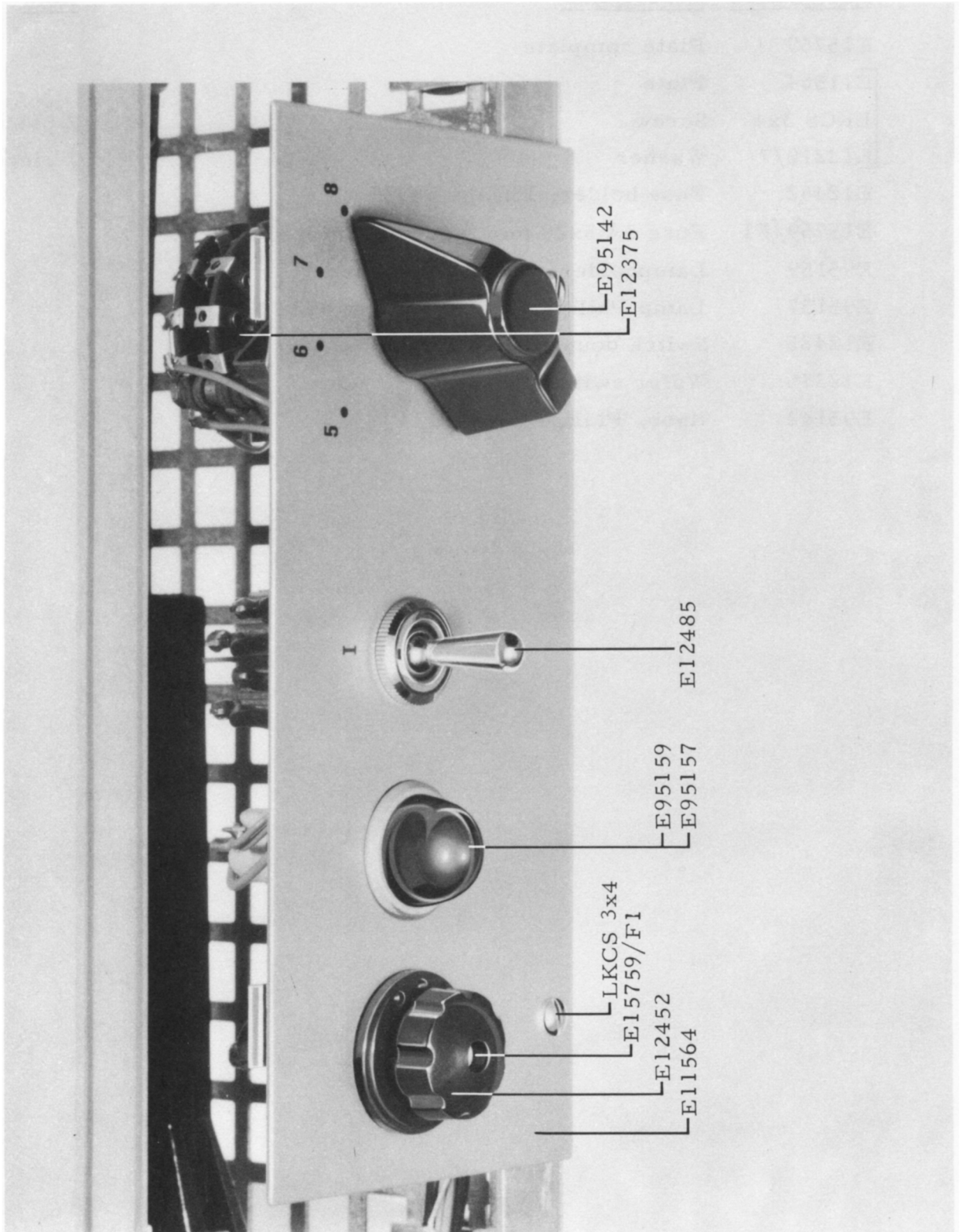

3.3 CONTROLS

<u>Designation</u>	<u>Description</u>	<u>Note</u>
E15759	Plate complete	
E11564	Plate	
LKCS 3x4	Screw	2 pieces
E12210/7	Washer	2 pieces
E12452	Fuse holder, Philips 88095	
E15759/F1	Fuse 3A 5x20 mm (approx. 5x25/32")	
E95159	Lampholder, Rafi 2214-A4 red	
E95157	Lamp Philips 12V O, 1A type 8089 N/00	
E12485	Switch double pole, Bulgin S277PD	
E12375	Wafer switch	
E95142	Knob, Philips CA 40x1/4"	

3.4 POWER UNIT

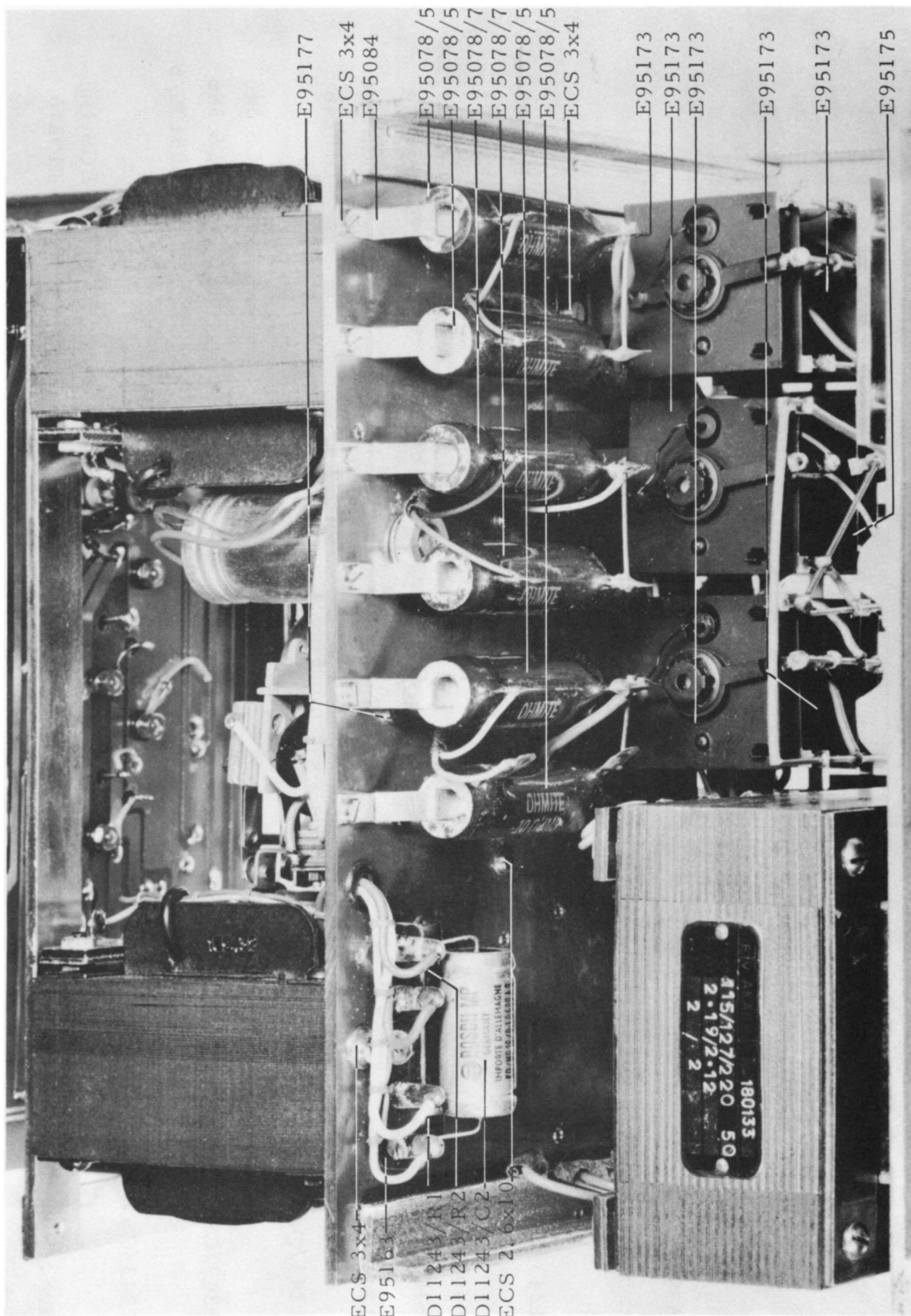

3.4 POWER UNIT

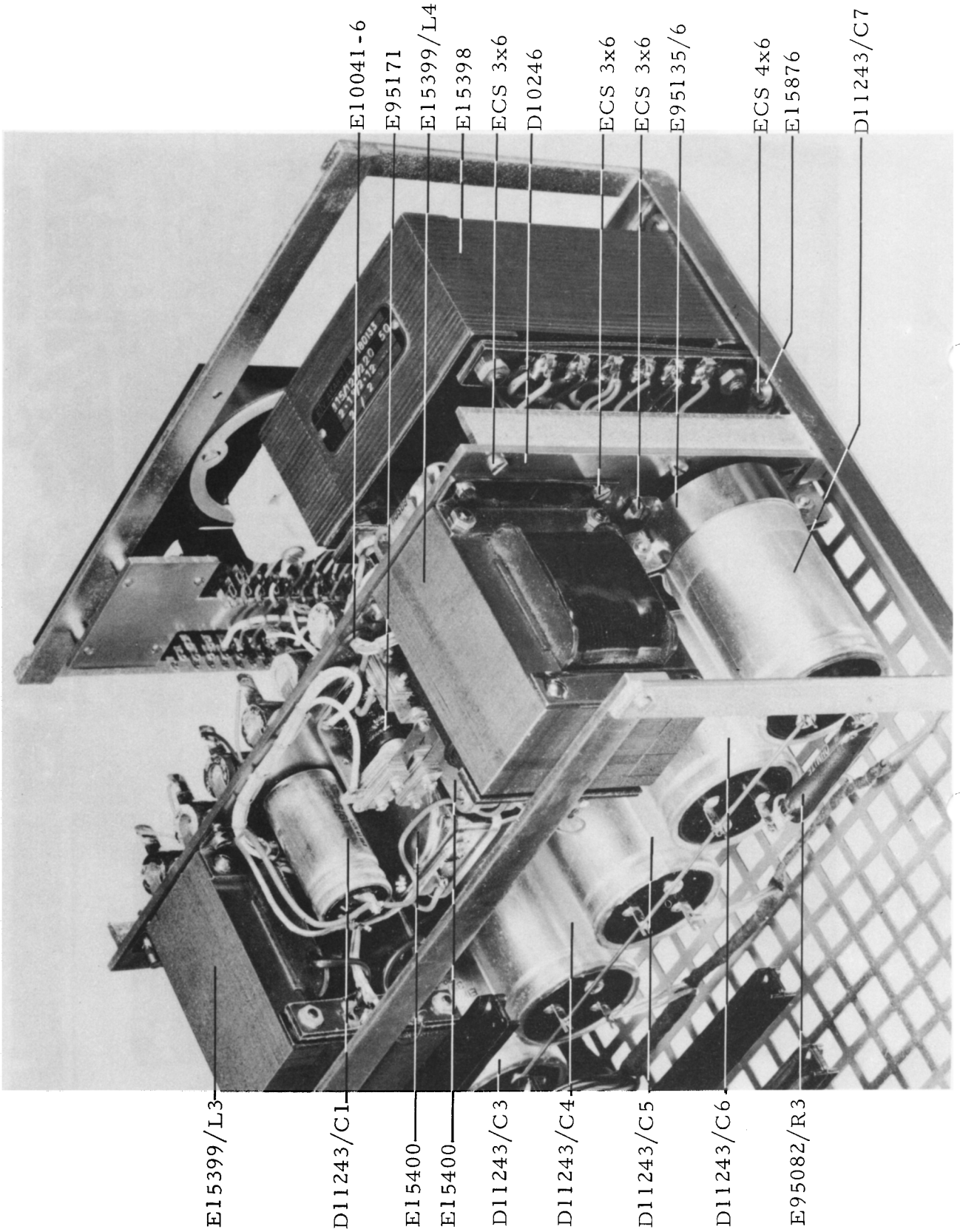

3.4 POWER UNIT

<u>Designation</u>	<u>Description</u>	<u>Note</u>
D11243	Power unit complete	
D10246	Plate	
ECS 3x6	Screw	4 pieces
E10041-6	Rubber grommet	
E15398	Transformer	
ECS 4x6	Screw	4 pieces
E15876	Washer	4 pieces
E15399/L3	Choke 0.05H 0.38 ohms	
E15399/L4	Choke 0.05H 0.38 ohms	
ECS 3x6	Screw	8 pieces
E15400	Choke L1 and L2 3 mH 0.6 ohms	2 pieces
ECS 2.6x10	Screw	4 pieces
E95173	Diode pair General Electric 4JA211 BC1BC1	5 pieces
E95175	Diode pair General Electric 4JA211 BC1AC1	
ECS 3x4	Screw	12 pieces
E95082/R3	Resistor Ohmite Brown Devil 7.5 ohms 10W	
E95084/5	Resistor Ohmite 0200B 10 ohms 25W	
E95084/5	Resistor Ohmite 0200B 10 ohms 25W	
E95078/7	Resistor Ohmite Fixed Resistor 25 ohms 25W	
E95078/7	Resistor Ohmite Fixed Resistor 25 ohms 25W	
E95078/5	Resistor Ohmite 0200B 10 ohms 25W	
E95078/5	Resistor Ohmite 0200B 10 ohms 25W	
E95084	Holder	12 pieces
ECS 3x4	Screw	12 pieces

<u>Designation</u>	<u>Description</u>	<u>Note</u>
D11243/R2	Resistor Allen Bradley HB 10 ohms 2W 10%	
D11243/R1	Resistor Allen Bradley HB 10 ohms 2W 10%	
D11243/C1	Capacitor Bosch KO/MP 25/1 G630/1	
D11243/C3	Capacitor 2500 μ F Siemens electrolytic 2500 μ F/ /35V Bv 43485	
D11243/C4	Capacitor 2500 μ F Siemens electrolytic 2500 μ F/ /35V Bv 43485	
D11243/C5	Capacitor 2500 μ F Siemens electrolytic 2500 μ F/ /35V Bv 43485	
D11243/C6	Capacitor 2500 μ F Siemens electrolytic 2500 μ F/ /35V Bv 43485	
D11243/C7	Capacitor 2500 μ F Siemens electrolytic 2500 μ F/ /35V Bv 43485	
E95135/6	Capacitor mounting	5 pieces
ECS 3x6	Screw	10 pieces
D11243/C2	Capacitor 0.1 μ F Bosch KO/MP 16/0.1 G500A3	
E95163	Wiring support Elfa K352	
ECS 3x4	Screw	
E95171	Relay	
E95177	Screw	4 pieces

3.5.1 Board 1

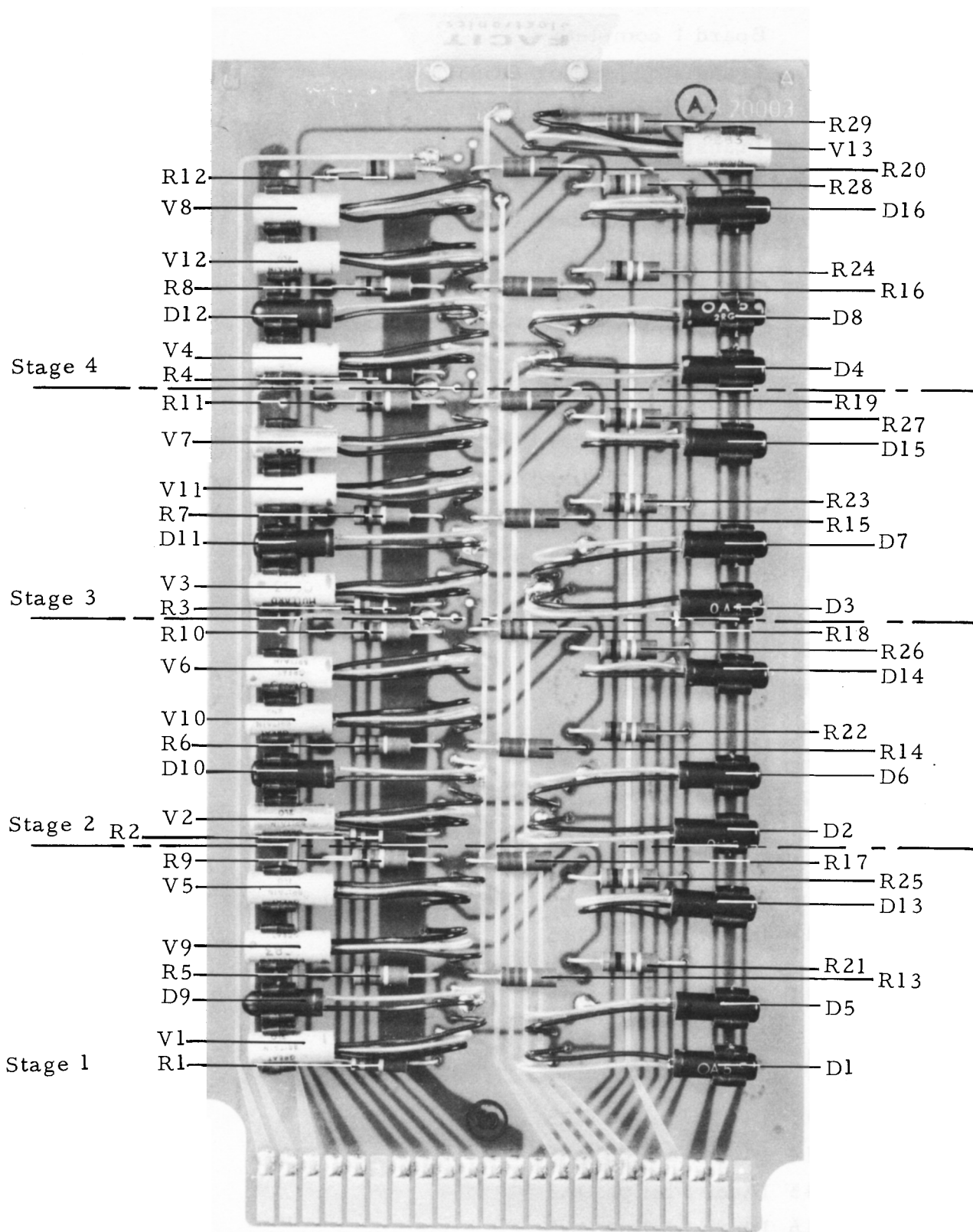

3.5.1 Board 1

<u>Designation</u>	<u>Description</u>	<u>Note</u>
E11527	Board 1 complete	
E11527/V1	Transistor Mullard OC83	
E11527/V2	Transistor Mullard OC83	
E11527/V3	Transistor Mullard OC83	
E11527/V4	Transistor Mullard OC83	
E11527/V5	Transistor Mullard OC83	
E11527/V6	Transistor Mullard OC83	
E11527/V7	Transistor Mullard OC83	
E11527/V8	Transistor Mullard OC83	
E11527/V9	Transistor Mullard OC83	
E11527/V10	Transistor Mullard OC83	
E11527/V11	Transistor Mullard OC83	
E11527/V12	Transistor Mullard OC83	
E11527/V13	Transistor Mullard OC83	
E11527/D1	Diode Philips OA5	
E11527/D2	Diode Philips OA5	
E11527/D3	Diode Philips OA5	
E11527/D4	Diode Philips OA5	
E11527/D5	Diode Philips OA5	
E11527/D6	Diode Philips OA5	
E11527/D7	Diode Philips OA5	
E11527/D8	Diode Philips OA5	
E11527/D9	Diode Philips OA5	
E11527/D10	Diode Philips OA5	
E11527/D11	Diode Philips OA5	
E11527/D12	Diode Philips OA5	
E11527/D13	Diode Philips OA5	
E11527/D14	Diode Philips OA5	
E11527/D15	Diode Philips OA5	
E11527/D16	Diode Philips OA5	

<u>Designation</u>	<u>Description</u>	<u>Note</u>
E11527/R1	Resistor Allen Bradley EB 4.7 kohm 1/2W 10%	
E11527/R2	Resistor Allen Bradley EB 4.7 kohm 1/2W 10%	
E11527/R3	Resistor Allen Bradley EB 4.7 kohm 1/2W 10%	
E11527/R4	Resistor Allen Bradley EB 4.7 kohm 1/2W 10%	
E11527/R5	Resistor Allen Bradley EB 1 kohm 1/2W 10%	
E11527/R6	Resistor Allen Bradley EB 1 kohm 1/2W 10%	
E11527/R7	Resistor Allen Bradley EB 1 kohm 1/2W 10%	
E11527/R8	Resistor Allen Bradley EB 1 kohm 1/2W 10%	
E11527/R9	Resistor Allen Bradley EB 1 kohm 1/2W 10%	
E11527/R10	Resistor Allen Bradley EB 1 kohm 1/2W 10%	
E11527/R11	Resistor Allen Bradley EB 1 kohm 1/2W 10%	
E11527/R12	Resistor Allen Bradley EB 1 kohm 1/2W 10%	
E11527/R13	Resistor Allen Bradley EB 2.2 kohm 1/2W 10%	
E11527/R14	Resistor Allen Bradley EB 2.2 kohm 1/2W 10%	
E11527/R15	Resistor Allen Bradley EB 2.2 kohm 1/2W 10%	
E11527/R16	Resistor Allen Bradley EB 2.2 kohm 1/2W 10%	
E11527/R17	Resistor Allen Bradley EB 2.2 kohm 1/2W 10%	
E11527/R18	Resistor Allen Bradley EB 2.2 kohm 1/2W 10%	
E11527/R19	Resistor Allen Bradley EB 2.2 kohm 1/2W 10%	
E11527/R20	Resistor Allen Bradley EB 2.2 kohm 1/2W 10%	
E11527/R21	Resistor Allen Bradley EB 10 kohm 1/2W 10%	
E11527/R22	Resistor Allen Bradley EB 10 kohm 1/2W 10%	
E11527/R23	Resistor Allen Bradley EB 10 kohm 1/2W 10%	
E11527/R24	Resistor Allen Bradley EB 10 kohm 1/2W 10%	
E11527/R25	Resistor Allen Bradley EB 10 kohm 1/2W 10%	
E11527/R26	Resistor Allen Bradley EB 10 kohm 1/2W 10%	
E11527/R27	Resistor Allen Bradley EB 10 kohm 1/2W 10%	
E11527/R28	Resistor Allen Bradley EB 10 kohm 1/2W 10%	
E11527/R29	Resistor Allen Bradley EB 2.2 kohm 1/2W 10%	
E12105	Transistor mounting clip	29 pieces

3.5.2 Board 2

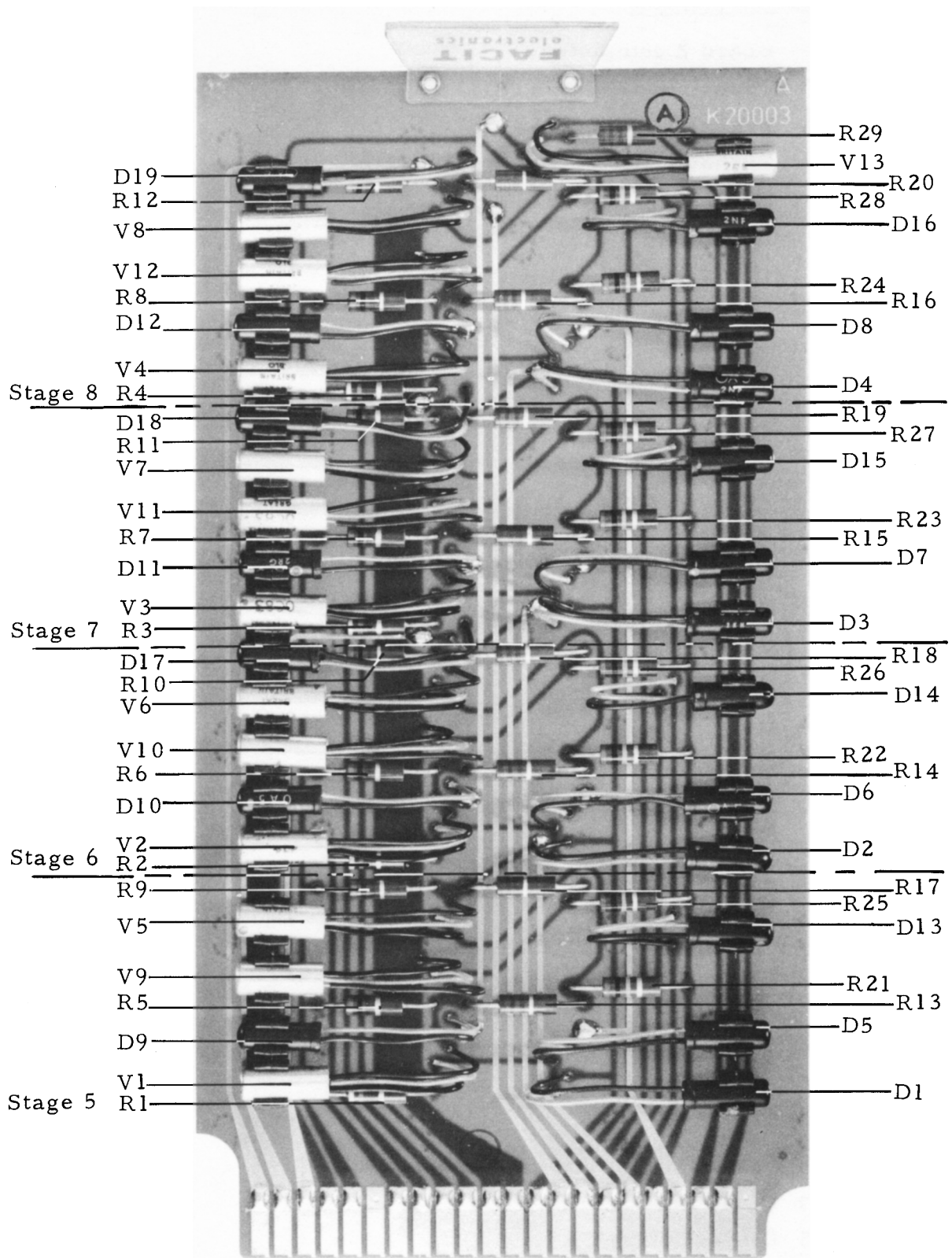

3.5.2 Board 2

<u>Designation</u>	<u>Description</u>	<u>Note</u>
E11528	Board 2 complete	
E11528/V1	Transistor Mullard OC83	
E11528/V2	Transistor Mullard OC83	
E11528/V3	Transistor Mullard OC83	
E11528/V4	Transistor Mullard OC83	
E11528/V5	Transistor Mullard OC83	
E11528/V6	Transistor Mullard OC83	
E11528/V7	Transistor Mullard OC83	
E11528/V8	Transistor Mullard OC83	
E11528/V9	Transistor Mullard OC83	
E11528/V10	Transistor Mullard OC83	
E11528/V11	Transistor Mullard OC83	
E11528/V12	Transistor Mullard OC83	
E11528/V13	Transistor Mullard OC83	
E11528/D1	Diode Philips OA5	
E11528/D2	Diode Philips OA5	
E11528/D3	Diode Philips OA5	
E11528/D4	Diode Philips OA5	
E11528/D5	Diode Philips OA5	
E11528/D6	Diode Philips OA5	
E11528/D7	Diode Philips OA5	
E11528/D8	Diode Philips OA5	
E11528/D9	Diode Philips OA5	
E11528/D10	Diode Philips OA5	
E11528/D11	Diode Philips OA5	
E11528/D12	Diode Philips OA5	
E11528/D13	Diode Philips OA5	
E11528/D14	Diode Philips OA5	
E11528/D15	Diode Philips OA5	
E11528/D16	Diode Philips OA5	
E11528/D17	Diode Philips OA5	

<u>Designation</u>	<u>Description</u>	<u>Note</u>
E11528/D18	Diode Philips OA5	
E11528/D19	Diode Philips OA5	
E11528/R1	Resistor Allen Bradley EB 4.7 kohm 1/2W 10%	
E11528/R2	Resistor Allen Bradley EB 4.7 kohm 1/2W 10%	
E11528/R3	Resistor Allen Bradley EB 4.7 kohm 1/2W 10%	
E11528/R4	Resistor Allen Bradley EB 4.7 kohm 1/2W 10%	
E11528/R5	Resistor Allen Bradley EB 1 kohm 1/2W 10%	
E11528/R6	Resistor Allen Bradley EB 1 kohm 1/2W 10%	
E11528/R7	Resistor Allen Bradley EB 1 kohm 1/2W 10%	
E11528/R8	Resistor Allen Bradley EB 1 kohm 1/2W 10%	
E11528/R9	Resistor Allen Bradley EB 1 kohm 1/2W 10%	
E11528/R10	Resistor Allen Bradley EB 1 kohm 1/2W 10%	
E11528/R11	Resistor Allen Bradley EB 1 kohm 1/2W 10%	
E11528/R12	Resistor Allen Bradley EB 1 kohm 1/2W 10%	
E11528/R13	Resistor Allen Bradley EB 2.2 kohm 1/2W 10%	
E11528/R14	Resistor Allen Bradley EB 2.2 kohm 1/2W 10%	
E11528/R15	Resistor Allen Bradley EB 2.2 kohm 1/2W 10%	
E11528/R16	Resistor Allen Bradley EB 2.2 kohm 1/2W 10%	
E11528/R17	Resistor Allen Bradley EB 2.2 kohm 1/2W 10%	
E11528/R18	Resistor Allen Bradley EB 2.2 kohm 1/2W 10%	
E11528/R19	Resistor Allen Bradley EB 2.2 kohm 1/2W 10%	
E11528/R20	Resistor Allen Bradley EB 2.2 kohm 1/2W 10%	
E11528/R21	Resistor Allen Bradley EB 10 kohm 1/2W 10%	
E11528/R22	Resistor Allen Bradley EB 10 kohm 1/2W 10%	
E11528/R23	Resistor Allen Bradley EB 10 kohm 1/2W 10%	
E11528/R24	Resistor Allen Bradley EB 10 kohm 1/2W 10%	
E11528/R25	Resistor Allen Bradley EB 10 kohm 1/2W 10%	
E11528/R26	Resistor Allen Bradley EB 10 kohm 1/2W 10%	
E11528/R27	Resistor Allen Bradley EB 10 kohm 1/2W 10%	
E11528/R28	Resistor Allen Bradley EB 10 kohm 1/2W 10%	
E11528/R29	Resistor Allen Bradley EB 2.2 kohm 1/2W 10%	
E12105	Transistor mounting clip	32 pieces

3.5.3 Board 3

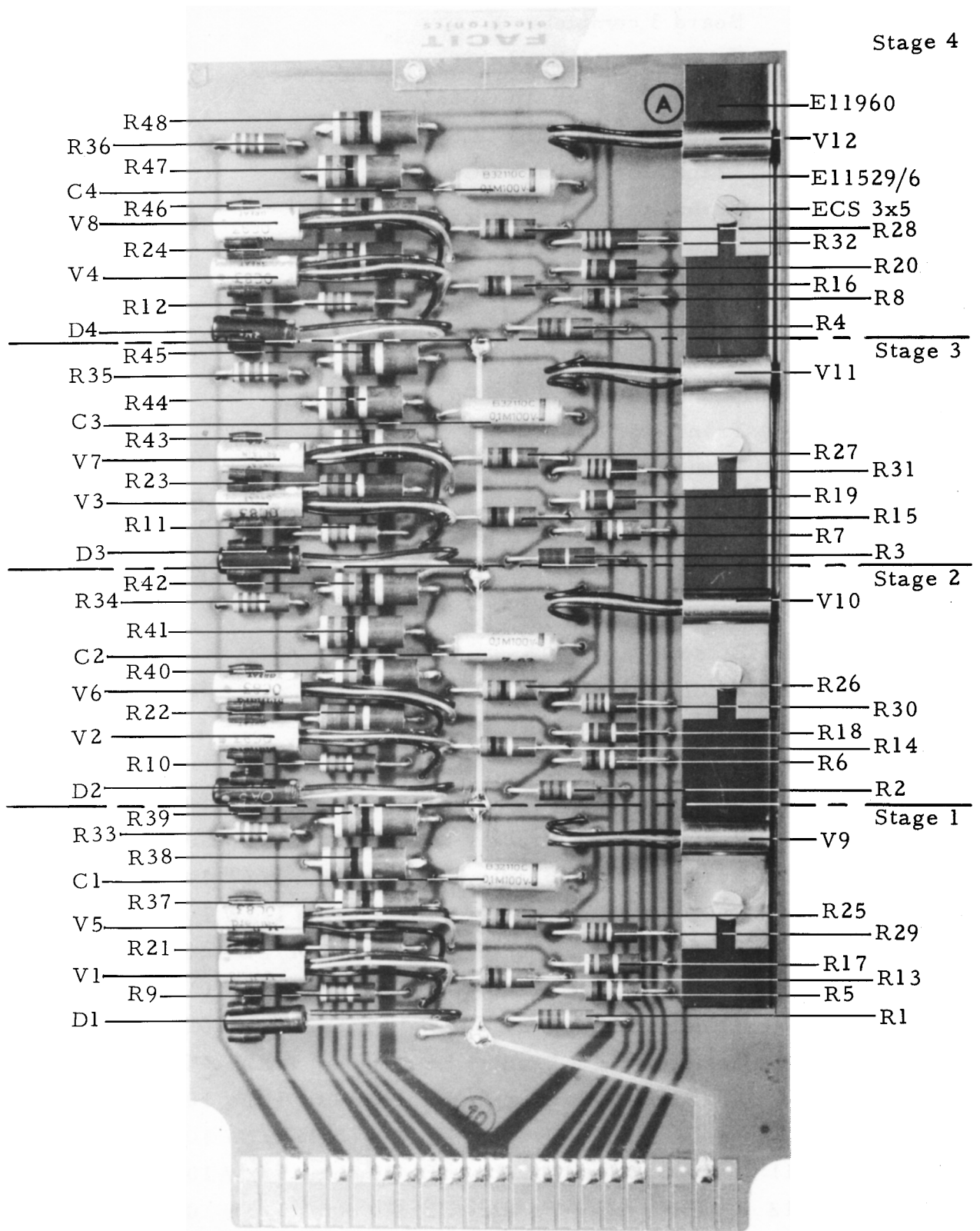

3.5.3 Board 3

<u>Designation</u>	<u>Description</u>	<u>Note</u>
E11529	Board 3 complete	
E11529/V1	Transistor Mullard OC83	
E11529/V2	Transistor Mullard OC83	
E11529/V3	Transistor Mullard OC83	
E11529/V4	Transistor Mullard OC83	
E11529/V5	Transistor Mullard OC83	
E11529/V6	Transistor Mullard OC83	
E11529/V7	Transistor Mullard OC83	
E11529/V8	Transistor Mullard OC83	
E11529/V9	Transistor Mullard OC83	
E11529/V10	Transistor Mullard OC83	
E11529/V11	Transistor Mullard OC83	
E11529/V12	Transistor Mullard OC83	
E11960	Radiator	
E11529/6	Radiator Philips 56200	4 pieces
ECS 3x5	Screw	4 pieces
LB6M 3	Nut	4 pieces
E11529/D1	Diode Philips OA5	
E11529/D2	Diode Philips OA5	
E11529/D3	Diode Philips OA5	
E11529/D4	Diode Philips OA5	
E11529/R1	Resistor Allen Bradley EB 2.2 kohm 1/2W 10%	
E11529/R2	Resistor Allen Bradley EB 2.2 kohm 1/2W 10%	
E11529/R3	Resistor Allen Bradley EB 2.2 kohm 1/2W 10%	
E11529/R4	Resistor Allen Bradley EB 2.2 kohm 1/2W 10%	
E11529/R5	Resistor Allen Bradley EB 10 kohm 1/2W 10%	
E11529/R6	Resistor Allen Bradley EB 10 kohm 1/2W 10%	
E11529/R7	Resistor Allen Bradley EB 10 kohm 1/2W 10%	
E11529/R8	Resistor Allen Bradley EB 10 kohm 1/2W 10%	
E11529/R9	Resistor Allen Bradley EB 470 ohms 1/2W 10%	
E11529/R10	Resistor Allen Bradley EB 470 ohms 1/2W 10%	
E11529/R11	Resistor Allen Bradley EB 470 ohms 1/2W 10%	
E11529/R12	Resistor Allen Bradley EB 470 ohms 1/2W 10%	
E11529/R13	Resistor Allen Bradley EB 1 kohm 1/2W 10%	

<u>Designation</u>	<u>Description</u>	<u>Note</u>
E11529/R14	Resistor Allen Bradley EB 1 kohm 1/2W 10%	
E11529/R15	Resistor Allen Bradley EB 1 kohm 1/2W 10%	
E11529/R16	Resistor Allen Bradley EB 1 kohm 1/2W 10%	
E11529/R17	Resistor Allen Bradley EB 4.7 kohm 1/2W 10%	
E11529/R18	Resistor Allen Bradley EB 4.7 kohm 1/2W 10%	
E11529/R19	Resistor Allen Bradley EB 4.7 kohm 1/2W 10%	
E11529/R20	Resistor Allen Bradley EB 4.7 kohm 1/2W 10%	
E11529/R21	Resistor Allen Bradley GB 150 ohms 1W 10%	
E11529/R22	Resistor Allen Bradley GB 150 ohms 1W 10%	
E11529/R23	Resistor Allen Bradley GB 150 ohms 1W 10%	
E11529/R24	Resistor Allen Bradley GB 150 ohms 1W 10%	
E11529/R25	Resistor Allen Bradley EB 68 ohms 1/2W 10%	
E11529/R26	Resistor Allen Bradley EB 68 ohms 1/2W 10%	
E11529/R27	Resistor Allen Bradley EB 68 ohms 1/2W 10%	
E11529/R28	Resistor Allen Bradley EB 68 ohms 1/2W 10%	
E11529/R29	Resistor Allen Bradley EB 680 ohms 1/2W 10%	
E11529/R30	Resistor Allen Bradley EB 680 ohms 1/2W 10%	
E11529/R31	Resistor Allen Bradley EB 680 ohms 1/2W 10%	
E11529/R32	Resistor Allen Bradley EB 680 ohms 1/2W 10%	
E11529/R33	Resistor Allen Bradley EB 330 ohms 1/2W 10%	
E11529/R34	Resistor Allen Bradley EB 330 ohms 1/2W 10%	
E11529/R35	Resistor Allen Bradley EB 330 ohms 1/2W 10%	
E11529/R36	Resistor Allen Bradley EB 330 ohms 1/2W 10%	
E11529/R37	Resistor Allen Bradley GB 47 ohms 1W 10%	
E11529/R38	Resistor Allen Bradley GB 47 ohms 1W 10%	
E11529/R39	Resistor Allen Bradley GB 47 ohms 1W 10%	
E11529/R40	Resistor Allen Bradley GB 47 ohms 1W 10%	
E11529/R41	Resistor Allen Bradley GB 47 ohms 1W 10%	
E11529/R42	Resistor Allen Bradley GB 47 ohms 1W 10%	
E11529/R43	Resistor Allen Bradley GB 47 ohms 1W 10%	
E11529/R44	Resistor Allen Bradley GB 47 ohms 1W 10%	
E11529/R45	Resistor Allen Bradley GB 47 ohms 1W 10%	
E11529/R46	Resistor Allen Bradley GB 47 ohms 1W 10%	
E11529/R47	Resistor Allen Bradley GB 47 ohms 1W 10%	
E11529/R48	Resistor Allen Bradley GB 47 ohms 1W 10%	

<u>Designation</u>	<u>Description</u>	<u>Note</u>
E11529/C1	Capacitor 0.1 μ F Siemens MKL 60V B32110A 0.1 M60	
E11529/C2	Capacitor 0.1 μ F Siemens MKL 60V B32110A 0.1 M60	
E11529/C3	Capacitor 0.1 μ F Siemens MKL 60V B32110A 0.1 M60	
E11529/C4	Capacitor 0.1 μ F Siemens MKL 60V B32110A 0.1 M60	
E12105	Transistor mounting clip	12 pieces

3.5.4 Board 4

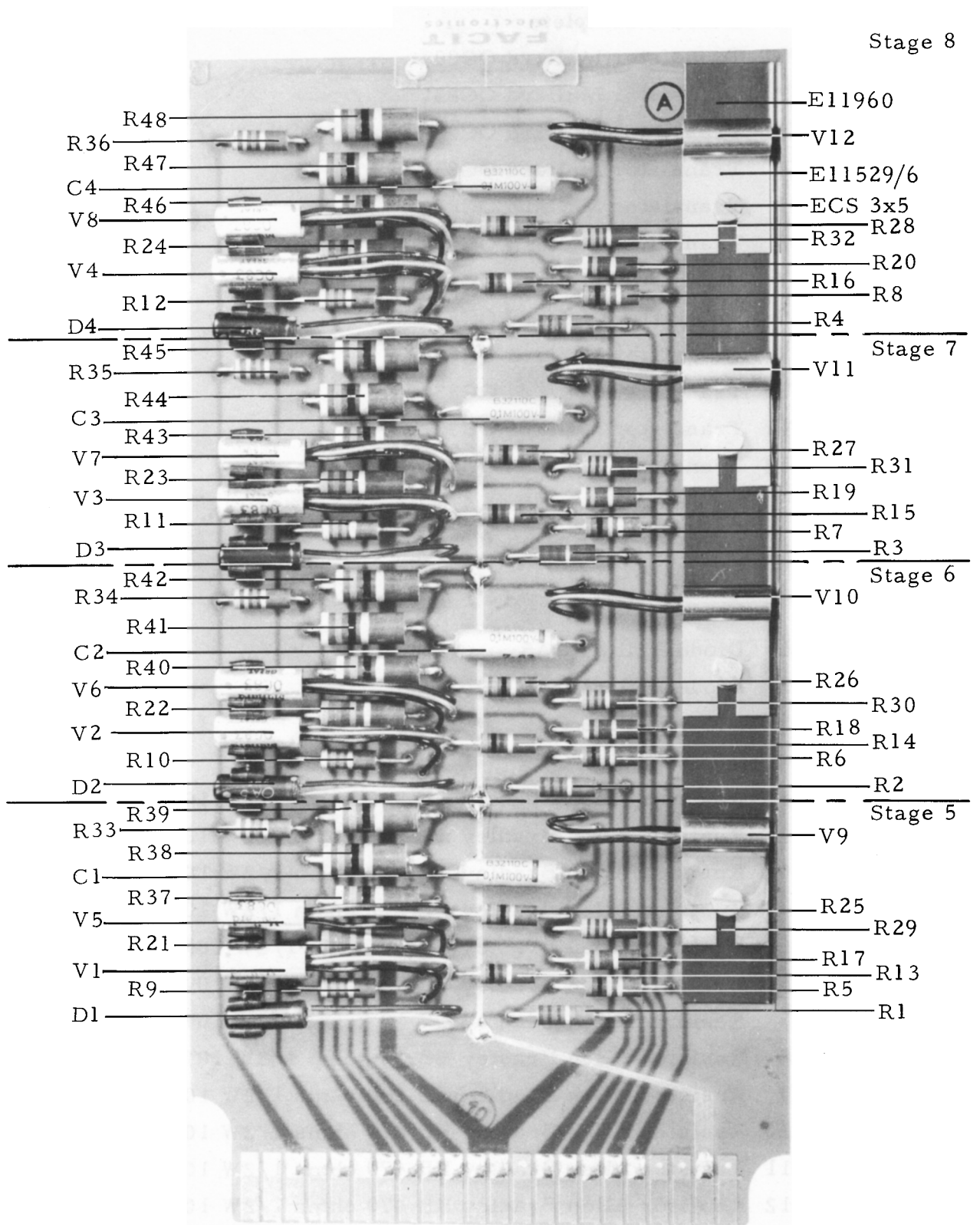

3.5.4 Board 4

<u>Designation</u>	<u>Description</u>	<u>Note</u>
E11530	Board 4 complete	
E11530/V1	Transistor Mullard OC83	
E11530/V2	Transistor Mullard OC83	
E11530/V3	Transistor Mullard OC83	
E11530/V4	Transistor Mullard OC83	
E11530/V5	Transistor Mullard OC83	
E11530/V6	Transistor Mullard OC83	
E11530/V7	Transistor Mullard OC83	
E11530/V8	Transistor Mullard OC83	
E11530/V9	Transistor Mullard OC83	
E11530/V10	Transistor Mullard OC83	
E11530/V11	Transistor Mullard OC83	
E11530/V12	Transistor Mullard OC83	
E11960	Radiator	
E11530/6	Radiator Philips 56200	4 pieces
ECS 3x5	Screw	4 pieces
LB6M 3	Nut	4 pieces
E11530/D1	Diode Philips OA5	
E11530/D2	Diode Philips OA5	
E11530/D3	Diode Philips OA5	
E11530/D4	Diode Philips OA5	
E11530/R1	Resistor Allen Bradley EB 2.2 kohm 1/2W 10%	
E11530/R2	Resistor Allen Bradley EB 2.2 kohm 1/2W 10%	
E11530/R3	Resistor Allen Bradley EB 2.2 kohm 1/2W 10%	
E11530/R4	Resistor Allen Bradley EB 2.2 kohm 1/2W 10%	
E11530/R5	Resistor Allen Bradley EB 10 kohm 1/2W 10%	
E11530/R6	Resistor Allen Bradley EB 10 kohm 1/2W 10%	
E11530/R7	Resistor Allen Bradley EB 10 kohm 1/2W 10%	
E11530/R8	Resistor Allen Bradley EB 10 kohm 1/2W 10%	
E11530/R9	Resistor Allen Bradley EB 470 ohms 1/2W 10%	
E11530/R10	Resistor Allen Bradley EB 470 ohms 1/2W 10%	
E11530/R11	Resistor Allen Bradley EB 470 ohms 1/2W 10%	
E11530/R12	Resistor Allen Bradley EB 470 ohms 1/2W 10%	
E11530/R13	Resistor Allen Bradley EB 1 kohm 1/2W 10%	

<u>Designation</u>	<u>Description</u>	<u>Note</u>
E11530/R14	Resistor Allen Bradley EB 1 kohm 1/2W 10%	
E11530/R15	Resistor Allen Bradley EB 1 kohm 1/2W 10%	
E11530/R16	Resistor Allen Bradley EB 1 kohm 1/2W 10%	
E11530/R17	Resistor Allen Bradley EB 4.7 kohm 1/2W 10%	
E11530/R18	Resistor Allen Bradley EB 4.7 kohm 1/2W 10%	
E11530/R19	Resistor Allen Bradley EB 4.7 kohm 1/2W 10%	
E11530/R20	Resistor Allen Bradley EB 4.7 kohm 1/2W 10%	
E11530/R21	Resistor Allen Bradley GB 150 ohms 1W 10%	
E11530/R22	Resistor Allen Bradley GB 150 ohms 1W 10%	
E11530/R23	Resistor Allen Bradley GB 150 ohms 1W 10%	
E11530/R24	Resistor Allen Bradley GB 150 ohms 1W 10%	
E11530/R25	Resistor Allen Bradley EB 68 ohms 1/2W 10%	
E11530/R26	Resistor Allen Bradley EB 68 ohms 1/2W 10%	
E11530/R27	Resistor Allen Bradley EB 68 ohms 1/2W 10%	
E11530/R28	Resistor Allen Bradley EB 68 ohms 1/2W 10%	
E11530/R29	Resistor Allen Bradley EB 680 ohms 1/2W 10%	
E11530/R30	Resistor Allen Bradley EB 680 ohms 1/2W 10%	
E11530/R31	Resistor Allen Bradley EB 680 ohms 1/2W 10%	
E11530/R32	Resistor Allen Bradley EB 680 ohms 1/2W 10%	
E11530/R33	Resistor Allen Bradley EB 330 ohms 1/2W 10%	
E11530/R34	Resistor Allen Bradley EB 330 ohms 1/2W 10%	
E11530/R35	Resistor Allen Bradley EB 330 ohms 1/2W 10%	
E11530/R36	Resistor Allen Bradley EB 330 ohms 1/2W 10%	
E11530/R37	Resistor Allen Bradley GB 47 ohms 1W 10%	
E11530/R38	Resistor Allen Bradley GB 47 ohms 1W 10%	
E11530/R39	Resistor Allen Bradley GB 47 ohms 1W 10%	
E11530/R40	Resistor Allen Bradley GB 47 ohms 1W 10%	
E11530/R41	Resistor Allen Bradley GB 47 ohms 1W 10%	
E11530/R42	Resistor Allen Bradley GB 47 ohms 1W 10%	
E11530/R43	Resistor Allen Bradley GB 47 ohms 1W 10%	
E11530/R44	Resistor Allen Bradley GB 47 ohms 1W 10%	
E11530/R45	Resistor Allen Bradley GB 47 ohms 1W 10%	
E11530/R46	Resistor Allen Bradley GB 47 ohms 1W 10%	
E11530/R47	Resistor Allen Bradley GB 47 ohms 1W 10%	
E11530/R48	Resistor Allen Bradley GB 47 ohms 1W 10%	

<u>Designation</u>	<u>Description</u>	<u>Note</u>
E11530/C1	Capacitor 0.1 μ F Siemens MKL 60V B32110A 0.1 M60	
E11530/C2	Capacitor 0.1 μ F Siemens MKL 60V B32110A 0.1 M60	
E11530/C3	Capacitor 0.1 μ F Siemens MKL 60V B32110A 0.1 M60	
E11530/C4	Capacitor 0.1 μ F Siemens MKL 60V B32110A 0.1 M60	
E12105	Transistor mounting clip	12 pieces

3.5.5 Board 5

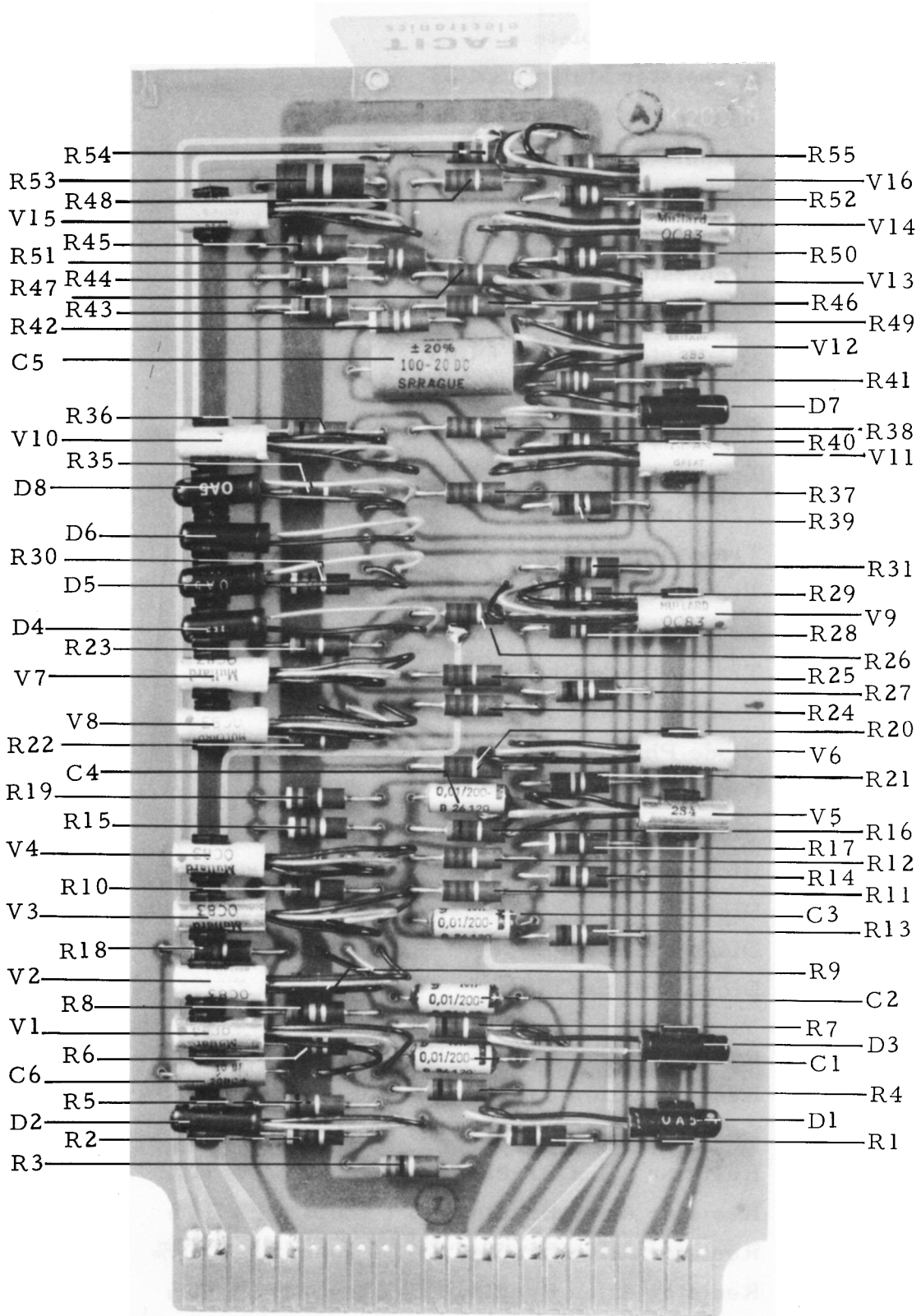

- R54
- R53
- V15
- R48
- R45
- R51
- R47
- R44
- R43
- R42
- C5
- R36
- V10
- R35
- D8
- D6
- R30
- D5
- D4
- R23
- V7
- V8
- R22
- C4
- R19
- R15
- V4
- R10
- V3
- R18
- V2
- R8
- V1
- R6
- C6
- R5
- D2
- R2
- R3
- R55
- V16
- R52
- V14
- R50
- V13
- R46
- R49
- V12
- R41
- D7
- R38
- R40
- V11
- R37
- R39
- R31
- R29
- V9
- R28
- R26
- R27
- R24
- R20
- V6
- R21
- V5
- R16
- R17
- R12
- R14
- R11
- C3
- R13
- R9
- C2
- R7
- D3
- C1
- R4
- D1
- R1

3.5.5 Board 5

<u>Designation</u>	<u>Description</u>	<u>Note</u>
D10238	Board 5 complete	
D10238/V1	Transistor Mullard OC83	
D10238/V2	Transistor Mullard OC83	
D10238/V3	Transistor Mullard OC83	
D10238/V4	Transistor Mullard OC83	
D10238/V5	Transistor Mullard OC83	
D10238/V6	Transistor Mullard OC83	
D10238/V7	Transistor Mullard OC83	
D10238/V8	Transistor Mullard OC83	
D10238/V9	Transistor Mullard OC83	
D10238/V10	Transistor Mullard OC83	
D10238/V11	Transistor Mullard OC83	
D10238/V12	Transistor Mullard OC83	
D10238/V13	Transistor Mullard OC83	
D10238/V14	Transistor Mullard OC83	
D10238/V15	Transistor Mullard OC83	
D10238/V16	Transistor Mullard OC83	
D10238/D1	Diode Philips OA5	
D10238/D2	Diode Philips OA5	
D10238/D3	Diode Philips OA5	
D10238/D4	Diode Philips OA5	
D10238/D5	Diode Philips OA5	
D10238/D6	Diode Philips OA5	
D10238/D7	Diode Philips OA5	
D10238/D8	Diode Philips OA5	
D10238/R1	Resistor Allen Bradley EB 4.7 kohm 1/2W 10%	
D10228/R2	Resistor Allen Bradley EB 470 ohms 1/2W 10%	
D10238/R3	Resistor Allen Bradley EB 68 ohms 1/2W 10%	
D10238/R4	Resistor Allen Bradley EB 1 kohm 1/2W 10%	
D10238/R5	Resistor Allen Bradley EB 1 kohm 1/2W 10%	
D10238/R6	Resistor Allen Bradley EB 10 kohm 1/2W 10%	
D10238/R7	Resistor Allen Bradley EB 1 kohm 1/2W 10%	
D10238/R8	Resistor Allen Bradley EB 10 kohm 1/2W 10%	

<u>Designation</u>	<u>Description</u>	<u>Note</u>
D10238/R9	Resistor Allen Bradley EB 1 kohm 1/2W 10%	
D10238/R10	Resistor Allen Bradley EB 1 kohm 1/2W 10%	
D10238/R11	Resistor Allen Bradley EB 2.2 kohm 1/2W 10%	
D10238/R12	Resistor Allen Bradley EB 2.2 kohm 1/2W 10%	
D10238/R13	Resistor Allen Bradley EB 10 kohm 1/2W 10%	
D10238/R14	Resistor Allen Bradley EB 10 kohm 1/2W 10%	
D10238/R15	Resistor Allen Bradley EB 470 ohms 1/2W 10%	
D10238/R16	Resistor Allen Bradley EB 1 kohm 1/2W 10%	
D10238/R17	Resistor Allen Bradley EB 4.7 kohm 1/2W 10%	
D10238/R18	Resistor Allen Bradley HB 220 ohms 1/2W 10%	
D10238/R19	Resistor Allen Bradley EB 4.7 kohm 1/2W 10%	
D10238/R20	Resistor Allen Bradley EB 2.2 kohm 1/2W 10%	
D10238/R21	Resistor Allen Bradley EB 22 kohm 1/2W 10%	
D10238/R22	Resistor Allen Bradley EB 1 kohm 1/2W 10%	
D10238/R23	Resistor Allen Bradley EB 1 kohm 1/2W 10%	
D10238/R24	Resistor Allen Bradley EB 2.2 kohm 1/2W 10%	
D10238/R25	Resistor Allen Bradley EB 2.2 kohm 1/2W 10%	
D10238/R26	Resistor Allen Bradley EB 2.2 kohm 1/2W 10%	
D10238/R27	Resistor Allen Bradley EB 10 kohm 1/2W 10%	
D10238/R28	Resistor Allen Bradley EB 10 kohm 1/2W 10%	
D10238/R29	Resistor Allen Bradley EB 10 kohm 1/2W 10%	
D10238/R30	Resistor Allen Bradley EB 470 ohms 1/2W 10%	
D10238/R31	Resistor Allen Bradley EB 100 ohms 1/2W 10%	
D10238/R35	Resistor Allen Bradley EB 1 kohm 1/2W 10%	
D10238/R36	Resistor Allen Bradley EB 1 kohm 1/2W 10%	
D10238/R37	Resistor Allen Bradley EB 2.2 kohm 1/2W 10%	
D10238/R38	Resistor Allen Bradley EB 2.2 kohm 1/2W 10%	
D10238/R39	Resistor Allen Bradley EB 10 kohm 1/2W 10%	
D10238/R40	Resistor Allen Bradley EB 10 kohm 1/2W 10%	
D10238/R41	Resistor Allen Bradley EB 68 kohm 1/2W 10%	
D10238/R42	Resistor Allen Bradley EB 47 kohm 1/2W 10%	
D10238/R43	Resistor Allen Bradley EB 1 kohm 1/2W 10%	
D10238/R44	Resistor Allen Bradley EB 1 kohm 1/2W 10%	
D10238/R45	Resistor Allen Bradley EB 1 kohm 1/2W 10%	
D10238/R46	Resistor Allen Bradley EB 2.2 kohm 1/2W 10%	
D10238/R47	Resistor Allen Bradley EB 2.2 kohm 1/2W 10%	

<u>Designation</u>	<u>Description</u>	<u>Note</u>
D10238/R48	Resistor Allen Bradley EB 2.2 kohm 1/2W 10%	
D10238/R49	Resistor Allen Bradley EB 10 kohm 1/2W 10%	
D10238/R50	Resistor Allen Bradley EB 10 kohm 1/2W 10%	
D10238/R51	Resistor Allen Bradley EB 220 ohms 1/2W 10%	
D10238/R52	Resistor Allen Bradley EB 10 kohm 1/2W 10%	
D10238/R53	Resistor Allen Bradley GB 220 ohms 1W 10%	
D10238/R54	Resistor Allen Bradley EB 100 ohms 1/2W 10%	
D10238/R55	Resistor Allen Bradley EB 1 kohm 1/2W 10%	
D10238/C1	Capacitor 0.01 μ F Siemens 200V MP 0.01/200 B2612	Or Sprague 200V MP 0.01 μ F 118 PS4
D10238/C2	Capacitor 0.01 μ F Siemens 200V MP 0.01/200 B2612	Or Sprague 200V MP 0.01 μ F 118 PS4
D10238/C3	Capacitor 0.01 μ F Siemens 200V MP 0.01/200 B2612	Or Sprague 200V MP 0.01 μ F 118 PS4
D10238/C4	Capacitor 0.01 μ F Siemens 200V MP 0.01/200 B2612	Or Sprague 200V MP 0.01 μ F 118 PS4
D10238/C5	Capacitor 100 μ F Sprague 20V 107x0020	
D10238/C6	Capacitor 10 μ F Sprague 20V 106x0020	
E12105	Transistor mounting clip	24 pieces

3.5.6 Board 6

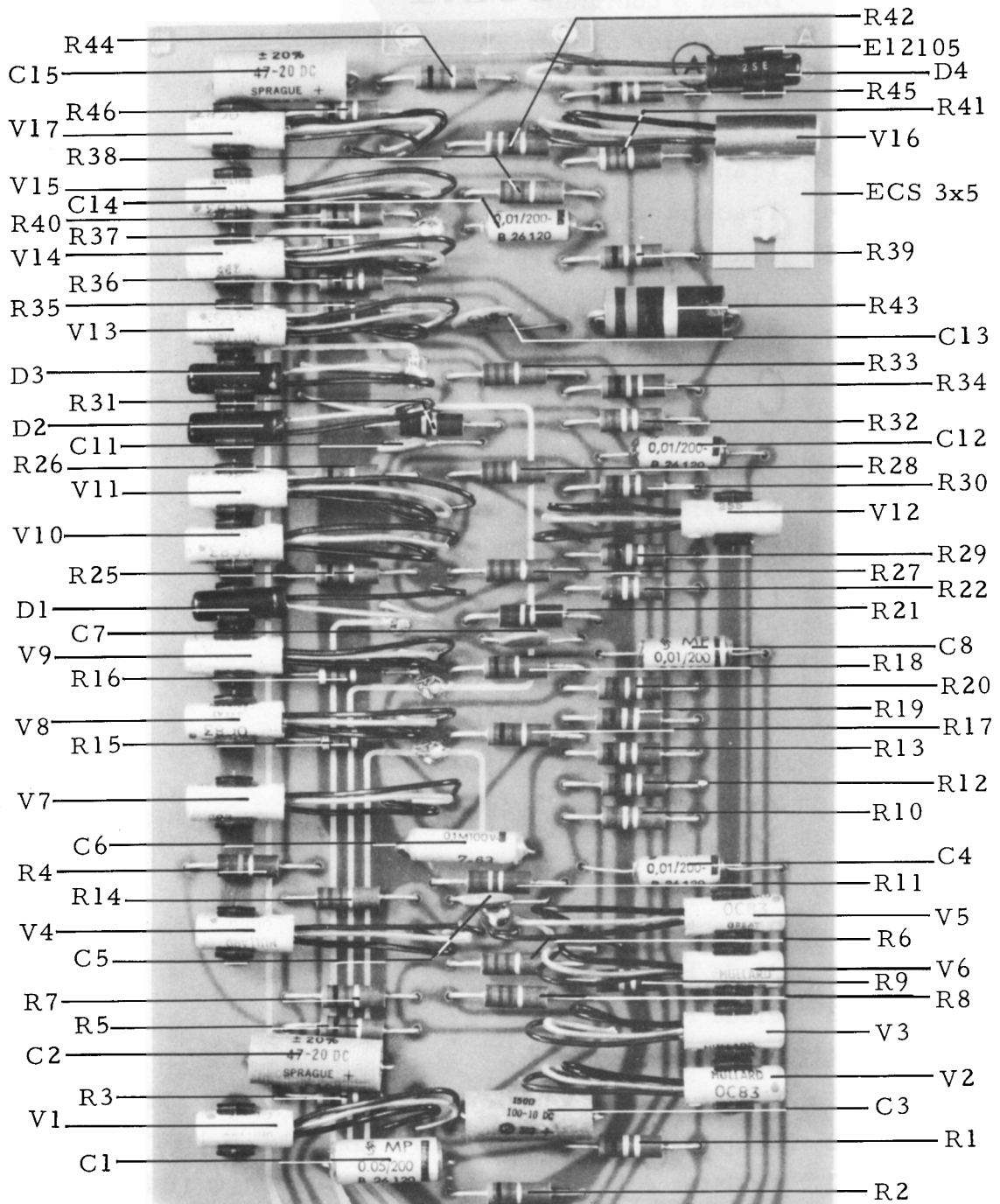

3.5.6 Board 6

<u>Designation</u>	<u>Description</u>	<u>Note</u>
D10239	Board 6 complete	
E12104	Transistor mounting clip	20 pieces
D10239/V1	Transistor Mullard OC83	
D10239 ¹ / ₅ V2	Transistor Mullard OC83	
D10239/V3	Transistor Mullard OC83	
D10239/V4	Transistor Mullard OC83	
D10239/V5	Transistor Mullard OC83	
D10239/V6	Transistor Mullard OC83	
D10239/V7	Transistor Mullard OC83	
D10239/V8	Transistor Mullard OC83	
D10239/V9	Transistor Mullard OC83	
D10239/V10	Transistor Mullard OC83	
D10239/V11	Transistor Mullard OC83	
D10239/V12	Transistor Mullard OC83	
D10239/V13	Transistor Mullard OC83	
D10239/V14	Transistor Mullard OC83	
D10239/V15	Transistor Mullard OC83	
D10239/V16	Transistor Mullard OC83	
D10239/V17	Transistor Mullard OC83	
D10239/6	Radiator Philips 56200	
ECS 3x5	Screw	
LB6M 3	Nut	
D10239/D1	Diode Philips OA5	
D10239/D2	Diode Philips OA5	
D10239/D3	Diode Philips OA5	
D10239/D4	Diode Philips OA5	
D10239/R1	Resistor Allen Bradley EB 10 kohm 1/2W 10%	
D10239/R2	Resistor Allen Bradley EB 1 kohm 1/2W 10%	
D10239/R3	Resistor Allen Bradley EB 10 kohm 1/2W 10%	
D10239/R4	Resistor Allen Bradley EB 220 ohms 1/2W 10%	
D10239/R5	Resistor Allen Bradley EB 1 kohm 1/2W 10%	
D10239/R6	Resistor Allen Bradley EB 2.2 kohm 1/2W 10%	
D10239/R7	Resistor Allen Bradley EB 1 kohm 1/2W 10%	
D10239/R8	Resistor Allen Bradley EB 2.2 kohm 1/2W 10%	

<u>Designation</u>	<u>Description</u>	<u>Note</u>
D10239/R9	Resistor Allen Bradley EB 10 kohm 1/2W 10%	
D10239/R10	Resistor Allen Bradley EB 150 kohm 1/2W 10%	
D10239/R11	Resistor Allen Bradley EB 22 kohm 1/2W 10%	
D10239/R12	Resistor Allen Bradley EB 10 kohm 1/2W 10%	
D10239/R13	Resistor Allen Bradley EB 10 kohm 1/2W 10%	
D10239/R14	Resistor Allen Bradley EB 2.2 kohm 1/2W 10%	
D10239/R15	Resistor Allen Bradley EB 470 ohms 1/2W 10%	
D10239/R16	Resistor Allen Bradley EB 470 ohms 1/2W 10%	
D10239/R17	Resistor Allen Bradley EB 1 kohm 1/2W 10%	
D10239/R18	Resistor Allen Bradley EB 1 kohm 1/2W 10%	
D10239/R19	Resistor Allen Bradley EB 10 kohm 1/2W 10%	
D10239/R20	Resistor Allen Bradley EB 10 kohm 1/2W 10%	
D10239/R21	Resistor Allen Bradley EB 22 kohm 1/2W 10%	
D10239/R22	Resistor Allen Bradley EB 150 kohm 1/2W 10%	
D10239/R25	Resistor Allen Bradley EB 1 kohm 1/2W 10%	
D10239/R26	Resistor Allen Bradley EB 1 kohm 1/2W 10%	
D10239/R27	Resistor Allen Bradley EB 2.2 kohm 1/2W 10%	
D10239/R28	Resistor Allen Bradley EB 2.2 kohm 1/2W 10%	
D10239/R29	Resistor Allen Bradley EB 10 kohm 1/2W 10%	
D10239/R30	Resistor Allen Bradley EB 10 kohm 1/2W 10%	
D10239/R31	Resistor Allen Bradley EB 22 kohm 1/2W 10%	
D10239/R32	Resistor Allen Bradley EB 150 kohm 1/2W 10%	
D10239/R33	Resistor Allen Bradley EB 2.2 kohm 1/2W 10%	
D10239/R34	Resistor Allen Bradley EB 10 kohm 1/2W 10%	
D10239/R35	Resistor Allen Bradley EB 1 kohm 1/2W 10%	
D10239/R36	Resistor Allen Bradley EB 10 kohm 1/2W 10%	
D10239/R37	Resistor Allen Bradley EB 1 kohm 1/2W 10%	
D10239/R38	Resistor Allen Bradley EB 2.2 kohm 1/2W 10%	
D10239/R39	Resistor Allen Bradley EB 10 kohm 1/2W 10%	
D10239/R40	Resistor Allen Bradley EB 1 kohm 1/2W 10%	
D10239/R41	Resistor Allen Bradley EB 470 ohms 1/2W 10%	
D10239/R42	Resistor Allen Bradley EB 33 ohms 1/2W 10%	
D10239/R43	Resistor Allen Bradley HB 68 ohms 2W 10%	
D10239/R44	Resistor Allen Bradley EB 1 kohm 1/2W 10%	
D10239/R45	Resistor Allen Bradley EB 10 kohm 1/2W 10%	
D10239/R46	Resistor Allen Bradley EB 10 kohm 1/2W 10%	

<u>Designation</u>	<u>Description</u>	<u>Note</u>
D10239/C1	Capacitor 0.047 μ F Siemens 200V MP 0.05/200 B2612	Or Sprague 200V MP 0.047 μ F 118 PS4
D10239/C2	Capacitor 47 μ F Sprague 20V 476x0020	
D10239/C3	Capacitor 100 μ F Sprague 10V 107x0016	
D10239/C4	Capacitor 0.01 μ F Siemens 200V MP 0.01/200 B2612	Or Sprague 200V MP 0.01 μ F 118 PS4
D10239/C5	Capacitor 2200 pF Sprague 19C250 \pm 10%	
D10239/C6	Capacitor 0.1 μ F Siemens MKL 60V B32110A 0.1 M60	
D10239/C7	Capacitor 2200 pF Sprague 19C250 \pm 10%	
D10239/C8	Capacitor 0.01 μ F Siemens 200V MP 0.01/200 B2612	Or Sprague 200V MP 0.01 μ F 118 PS4
D10239/C11	Capacitor 2200 pF Sprague 19C250 \pm 10%	
D10239/C12	Capacitor 0.01 μ F Siemens 200V MP 0.01/200 B2612	Or Sprague 200V MP 0.01 μ F 118 PS4
D10239/C13	Capacitor 4700 pF Sprague 55C33 \pm 20%	
D10239/C14	Capacitor 0.01 μ F Siemens 200V MP 0.01/200 B2612	Or Sprague 200V MP 0.01 μ F 118 PS4
D10239/C15	Capacitor 47 μ F Sprague 20V 476x0020	

3.5.7 Board 7

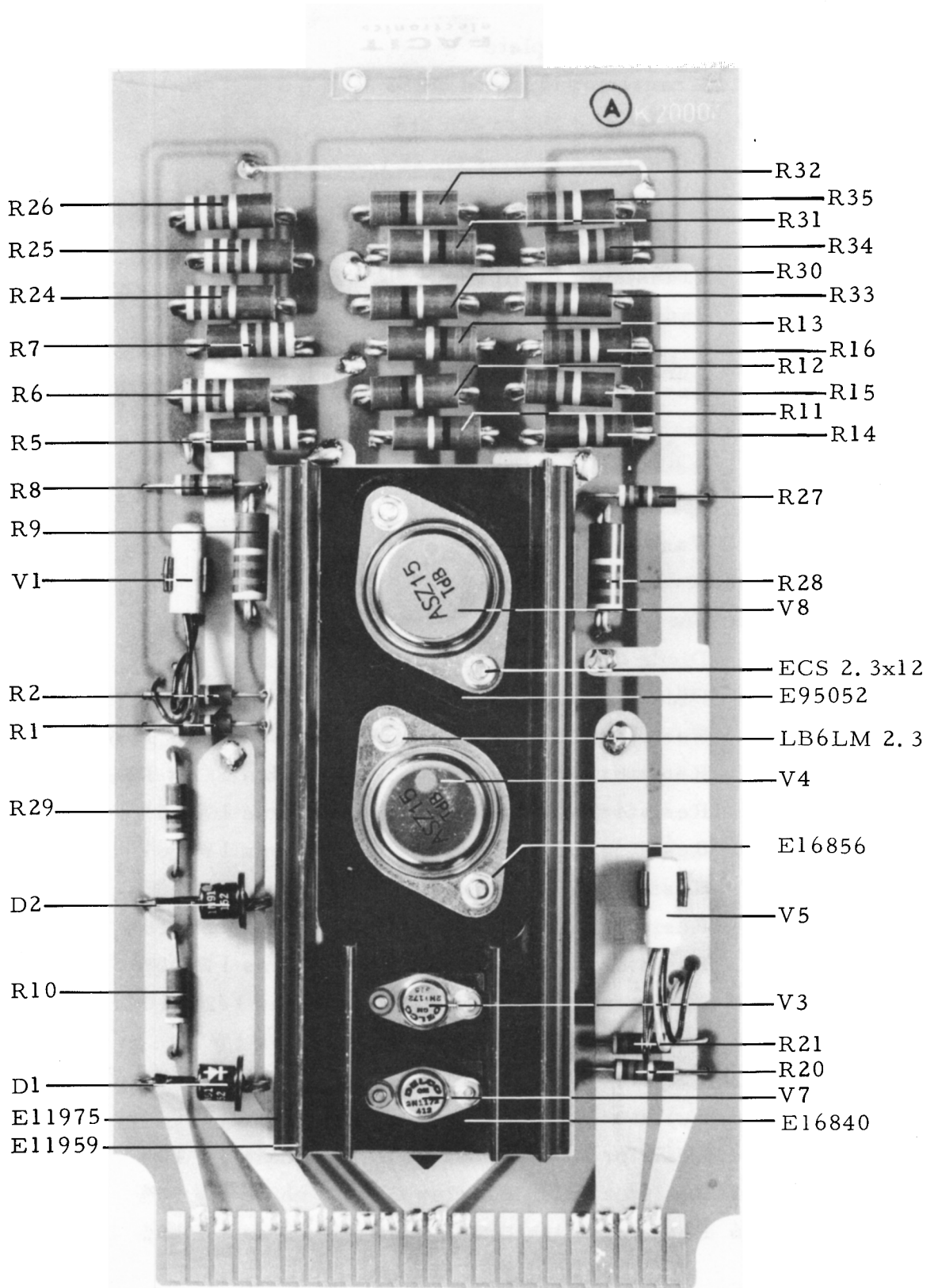

3.5.7 Board 7

<u>Designation</u>	<u>Description</u>	<u>Note</u>
E11531	Board 7 complete	
E11531/V1	Transistor Mullard OC83	
E11531/V3	Transistor Delco 2N3215	
E11531/V4	Transistor Philips OC28 (ASZ 15)	
E11531/V5	Transistor Philips OC83	
E11531/V7	Transistor Delco 2N3215	
E11531/V8	Transistor Philips OC28 (ASZ 15)	
E11959	Radiator	
E11975	Insulator	
E16840	Assembly set for V3 and V7	2 pieces
E95052	Insulator washer	2 pieces
E16856	Insulator bushing	4 pieces
FBB 2.4	Spring washer	4 pieces
E16857	Washer	2 pieces
ECS 2.3x12	Screw	4 pieces
LB6LM 2.3	Nut	4 pieces
E11531/D1	Diode General Electric IN91	
E11531/D2	Diode General Electric IN91	
E11531/R1	Resistor Allen Bradley EB 470 ohms 1/2W 10%	
E11531/R2	Resistor Allen Bradley EB 4.7 kohm 1/2W 10%	
E11531/R5	Resistor Allen Bradley GB 330 ohms 1W 10%	
E11531/R6	Resistor Allen Bradley GB 330 ohms 1W 10%	
E11531/R7	Resistor Allen Bradley GB 330 ohms 1W 10%	
E11531/R8	Resistor Allen Bradley EB 47 ohms 1/2W 10%	
E11531/R9	Resistor Allen Bradley GB 470 ohms 1W 10%	
E11531/R10	Resistor Allen Bradley EB 47 ohms 1/2W 10%	
E11531/R11	Resistor Allen Bradley GB 22 ohms 1W 10%	
E11531/R12	Resistor Allen Bradley GB 22 ohms 1W 10%	
E11531/R13	Resistor Allen Bradley GB 22 ohms 1W 10%	
E11531/R14	Resistor Allen Bradley GB 220 ohms 1W 10%	
E11531/R15	Resistor Allen Bradley GB 220 ohms 1W 10%	
E11531/R16	Resistor Allen Bradley GB 220 ohms 1W 10%	

<u>Designation</u>	<u>Description</u>	<u>Note</u>
E11531/R20	Resistor Allen Bradley EB 470 ohms 1/2W 10%	
E11531/R21	Resistor Allen Bradley EB 4.7 kohm 1/2W 10%	
E11531/R24	Resistor Allen Bradley GB 330 ohms 1W 10%	
E11531/R25	Resistor Allen Bradley GB 330 ohms 1W 10%	
E11531/R26	Resistor Allen Bradley GB 330 ohms 1W 10%	
E11531/R27	Resistor Allen Bradley EB 47 ohms 1/2W 10%	
E11531/R28	Resistor Allen Bradley GB 470 ohms 1W 10%	
E11531/R29	Resistor Allen Bradley EB 47 ohms 1/2W 10%	
E11531/R30	Resistor Allen Bradley GB 22 ohms 1W 10%	
E11531/R31	Resistor Allen Bradley GB 22 ohms 1W 10%	
E11531/R32	Resistor Allen Bradley GB 22 ohms 1W 10%	
E11531/R33	Resistor Allen Bradley GB 220 ohms 1W 10%	
E11531/R34	Resistor Allen Bradley GB 220 ohms 1W 10%	
E11531/R35	Resistor Allen Bradley GB 220 ohms 1W 10%	
E12105	Transistor mounting clip	2 pieces

4 ACCESSORIES

<u>Designation</u>	<u>Description</u>	<u>Note</u>
E14007	Protecting case for mechanical unit	
E14008	Protecting case for electronic unit	
E15517	Interconnection cable	
E14006	Cable plug	
E13426	Tool set with spacing template	
E14005	Spacing template	
E14009	Oil can	
E15325	Chad exhausted tube	
UGB 640424	Technical manual, Swedish	
UGB 640604	Technical manual, English	
TPU 620303	Parts list, Swedish	
UGB 650605	Parts list, English	
E14010	5-channel paper roll	
E14010/2	6- and 7-channel paper roll	
E14010/3	8-channel paper roll	
KS 996	Mains cable, two core	
KS 994	Mains cable, with sidegrounded plug	
KS 998	Mains cable, American type	

4 ACCESSORIES

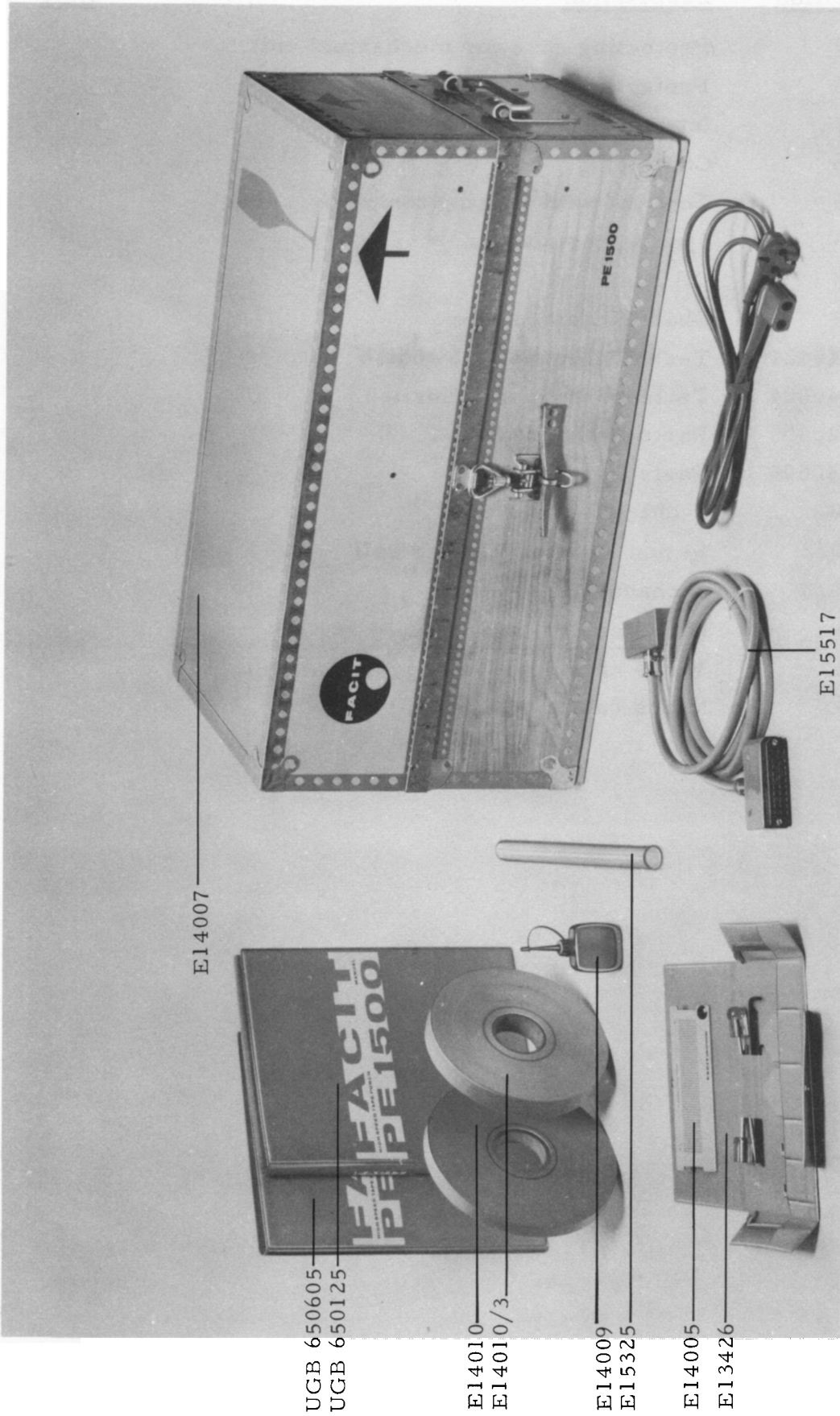

4 ACCESSORIES

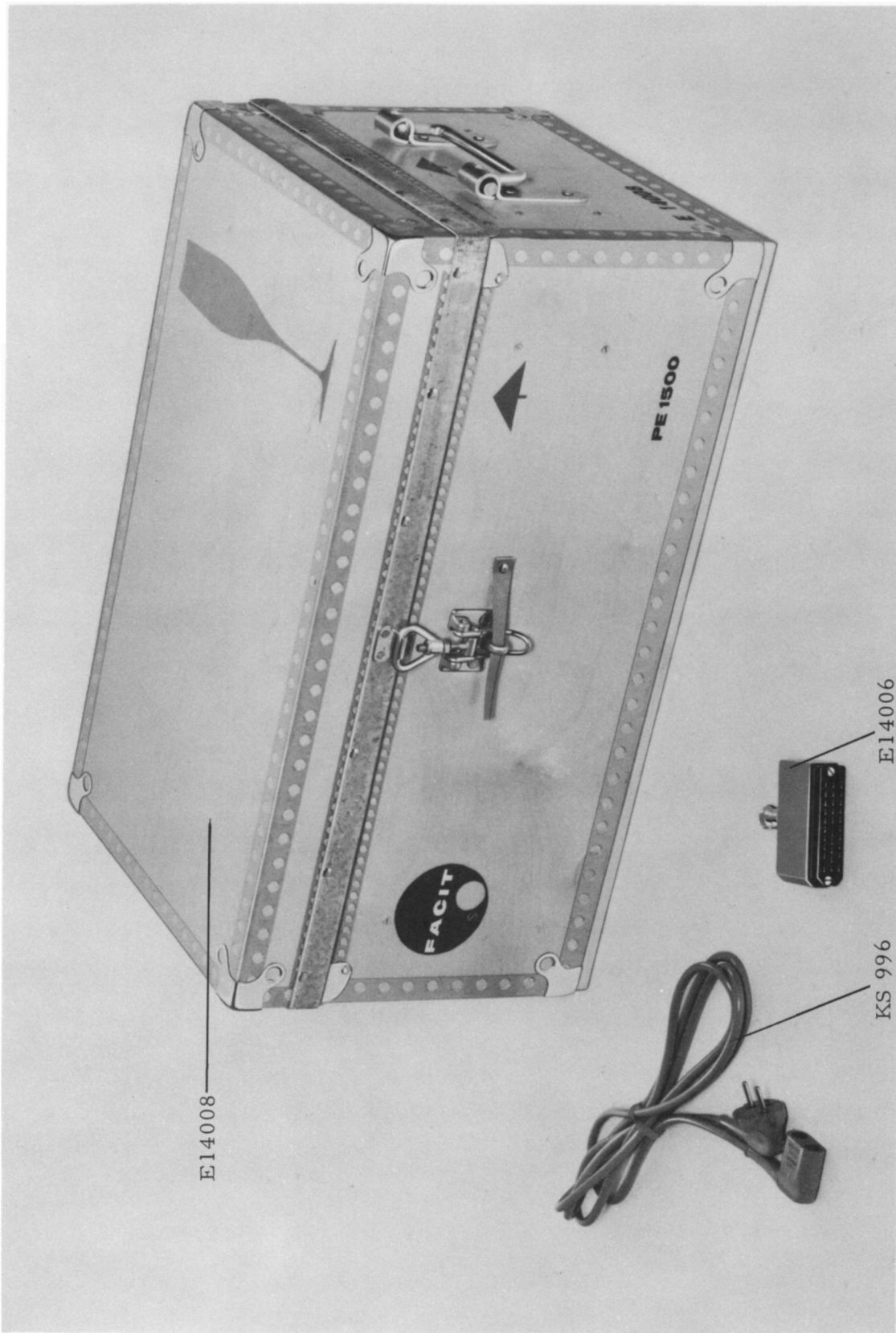

FACIT

ADDENDUM TO FACIT PE 1500 SPARE PARTS LIST UGB 650605.

FACIT PE 1511, PE 1512 AND PE 1513 TAPE PUNCH.

The punch units Facit PE 1511, PE 1512 and PE 1513 are equivalent to the versions in the spare parts list with the exception of the punch mechanism.

For spare part requisitions (except for the punch mechanism), note that Facit PE 1511, PE 1512 and PE 1513 correspond to Facit PE 1501, PE 1504 and PE 1502 respectively.

2.7 PUNCH MECHANISM (PE 1511, PE 1512 and PE 1513)

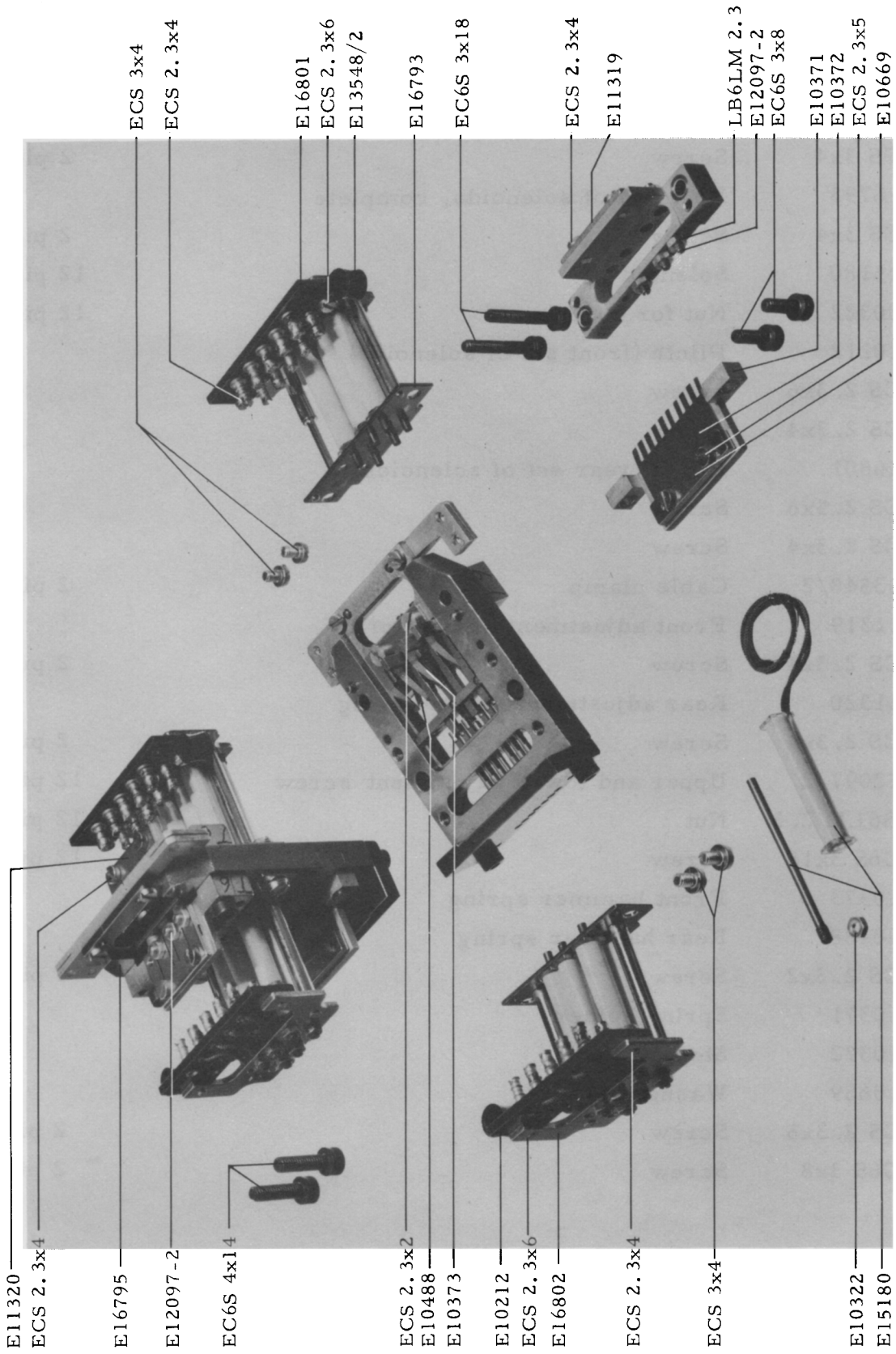

2.7 PUNCH MECHANISM (PE 1511, PE 1512 and PE 1513)

<u>Designation</u>	<u>Description</u>	<u>Note</u>
E16795	Punch mechanism, complete	
EC6S 4x14	Screw	2 pieces
E16802	Front set of solenoids, complete	
ECS 3x4	Screw	2 pieces
E16793	Rear set of solenoids, complete	
ECS 3x4	Screw	2 pieces
E15180	Solenoid	12 pieces
E10322	Nut for core	12 pieces
E10212	Plinth (front set of solenoids)	
ECS 2.3x6	Screw	
ECS 2.3x4	Screw	
E16801	Plinth (rear set of solenoids)	
ECS 2.3x6	Screw	
ECS 2.3x4	Screw	
E13548/2	Cable clamp	2 pieces
E11319	Front adjustment screw spring	
ECS 2.3x4	Screw	2 pieces
E11320	Rear adjustment screw spring	
ECS 2.3x4	Screw	2 pieces
E12097-2	Upper and lower adjustment screw	12 pieces
LB6LM 2.3	Nut	12 pieces
EC6S 3x18	Screw	12 pieces
E10373	Front hammer spring	
E10488	Rear hammer spring	
ECS 2.3x2	Screw	4 pieces
E10371	Spring holder	
E10372	Stop spring	
E10669	Washer	
ECS 2.3x5	Screw	2 pieces
EC6S 3x8	Screw	2 pieces